

FAGERHULT SE - 566 80 Habo

Pleiad G4 Recessed

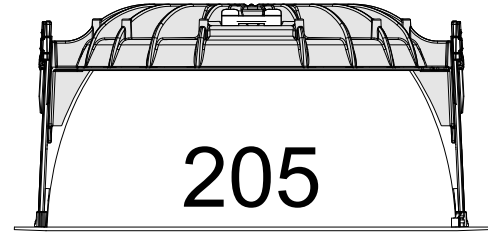
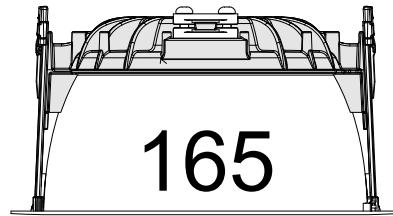
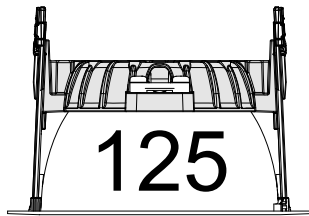
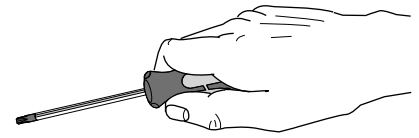

1 Ø - A mm
B mm

Model	A Diameter	B Thickness
125	Ø 125mm	5-50mm
165	Ø 165mm	5-50mm
205	Ø 205mm	5-50mm

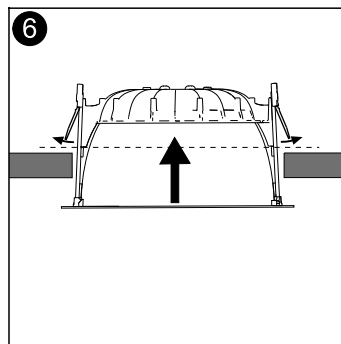
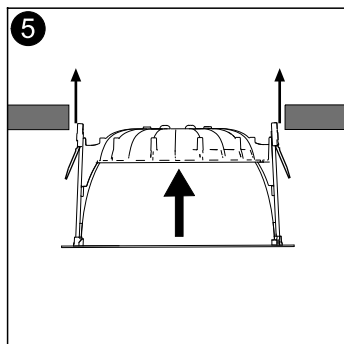
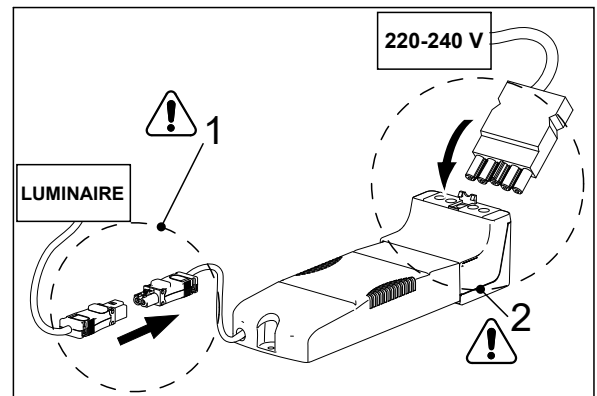
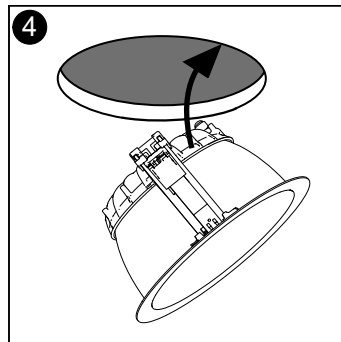
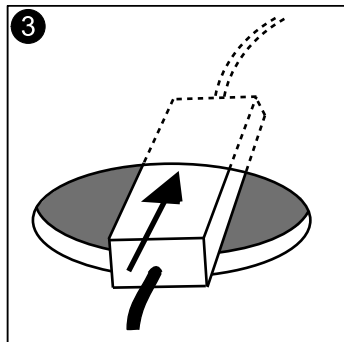
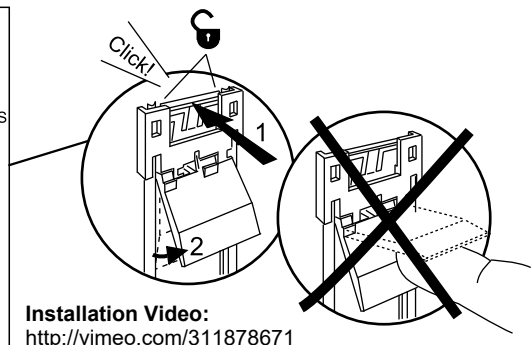
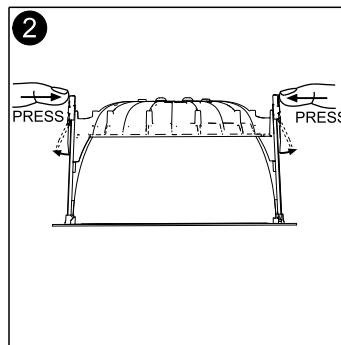

- S** Armaturdel **MÅSTE** anslutas innan nätspänning kopplas in!
- GB** The luminaire **MUST** be connected before plugging in the mains voltage!
- D** Die Leuchtenteil **MUSS** vor dem Einstecken der Netzspannung angeschlossen werden!

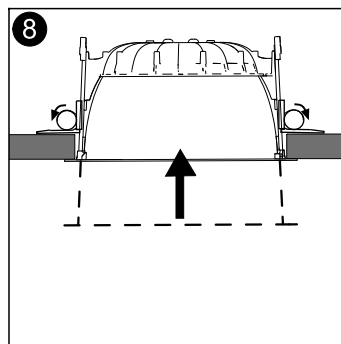
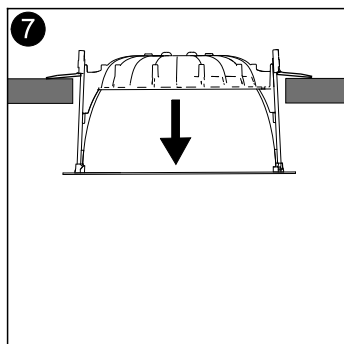

- S** Ljuskälla och drivdon ska enbart bytas ut av tillverkaren eller dess utsedda person.
- GB** The light source and control gear shall only be replaced by the manufacturer or its designated person.

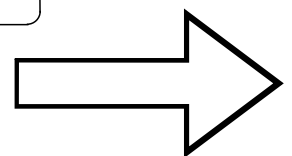

5421963 Utgåva/Edition 03

S Det är lämpligt att denna information överlämnas till användaren av anläggningen. **GB** It is appropriate that this information is passed on to the users of the installation.

Manufactured by Fagerhult Sweden.
For UK market importer Fagerhult UK
33-34 Dolben Street, London, SE1 0UQ

FAGERHULT SE - 566 80 Habo

Pleiad G4 Recessed

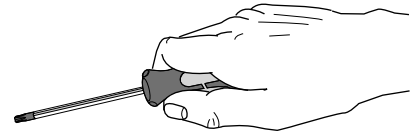

Removal Procedure

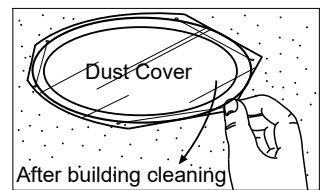
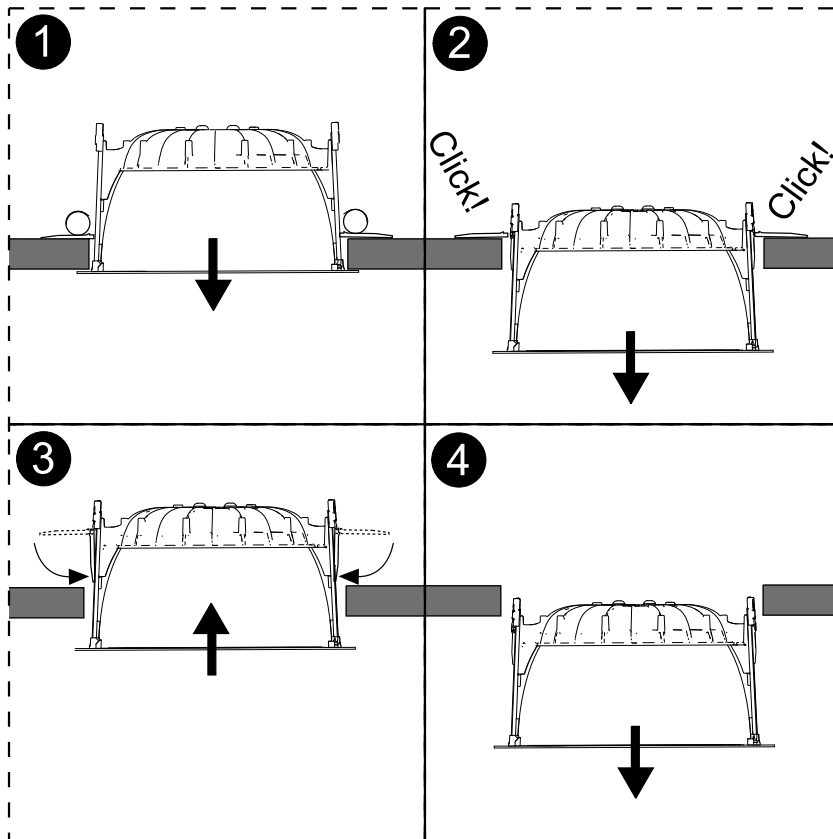

- (S)** För montering i ventilerat alternativt oventilerat utrymme.
- (GB)** For mounting in ventilated or unventilated space

<p>Får ej täckas med isolering Must not be covered with insulating material</p>	<p>Får täckas med isolering enligt tabell nedan May be covered with insulating material according to table below</p>	<p>Får ej täckas med isolering Must not be covered with insulating material</p>	<p>Får täckas med isolering enligt tabell nedan May be covered with insulating material according to table below</p>																				
<p>0mm</p>	<p>0mm</p>	<p>50mm</p>	<p>50mm</p>																				
<table border="1"> <thead> <tr> <th>Model</th> <th>Constant Current</th> </tr> </thead> <tbody> <tr> <td>125</td> <td>$\geq 475\text{mA}$</td> </tr> <tr> <td>165</td> <td>$\geq 700\text{mA}$</td> </tr> </tbody> </table>	Model	Constant Current	125	$\geq 475\text{mA}$	165	$\geq 700\text{mA}$	<table border="1"> <thead> <tr> <th>Model</th> <th>Constant Current</th> </tr> </thead> <tbody> <tr> <td>125</td> <td>$\leq 475\text{mA}$</td> </tr> <tr> <td>165</td> <td>$\leq 700\text{mA}$</td> </tr> </tbody> </table>	Model	Constant Current	125	$\leq 475\text{mA}$	165	$\leq 700\text{mA}$	<table border="1"> <thead> <tr> <th>Model</th> <th>Constant Current</th> </tr> </thead> <tbody> <tr> <td>205</td> <td>$\geq 900\text{mA}$</td> </tr> </tbody> </table>	Model	Constant Current	205	$\geq 900\text{mA}$	<table border="1"> <thead> <tr> <th>Model</th> <th>Constant Current</th> </tr> </thead> <tbody> <tr> <td>205</td> <td>$\leq 900\text{mA}$</td> </tr> </tbody> </table>	Model	Constant Current	205	$\leq 900\text{mA}$
Model	Constant Current																						
125	$\geq 475\text{mA}$																						
165	$\geq 700\text{mA}$																						
Model	Constant Current																						
125	$\leq 475\text{mA}$																						
165	$\leq 700\text{mA}$																						
Model	Constant Current																						
205	$\geq 900\text{mA}$																						
Model	Constant Current																						
205	$\leq 900\text{mA}$																						

- (S)** Om armaturens kabel skulle skadas eller om armaturen inte fungerar som den ska, skall dessa komponenter kontrolleras/bytas av tillverkaren eller av tillverkaren utsedd person
- (GB)** If the luminaire cable is damaged or if the luminaire is not working properly, it shall exclusively be checked/replaced by the manufacturer or by the manufacturer designated person.

- (S)** Ljuskälla och drivdon ska enbart bytas ut av tillverkaren eller dess utsedda person.
- (GB)** The light source and control gear shall only be replaced by the manufacturer or its designated person.

FAGERHULT SE - 566 80 Habo

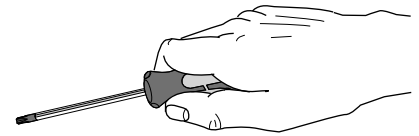

Pleiad G4 Recessed Dim to Warm

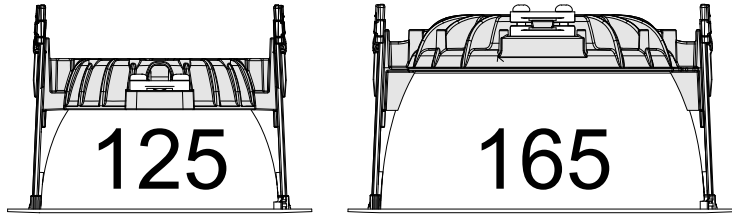

1 Ø - A mm
B mm

Model	A Diameter	B Thickness
125	Ø 125mm	5-50mm
165	Ø 165mm	5-50mm

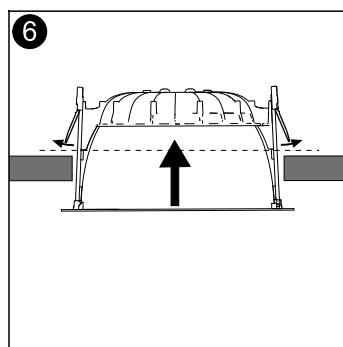
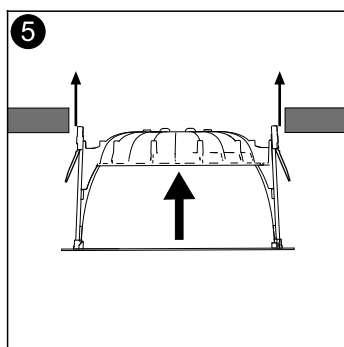
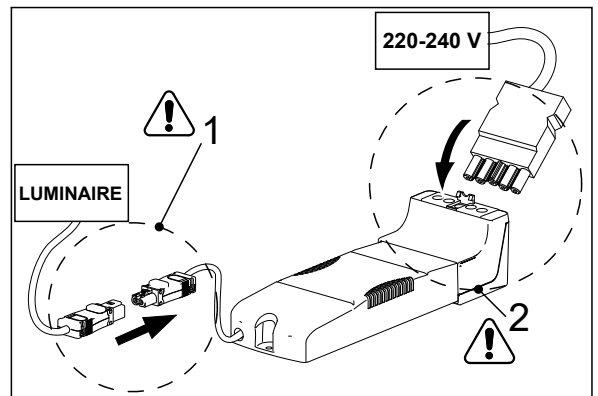
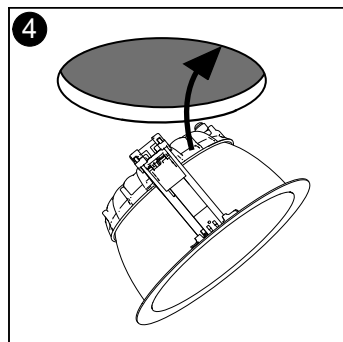
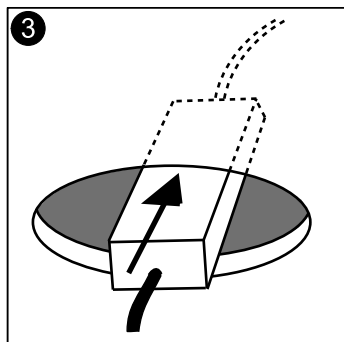
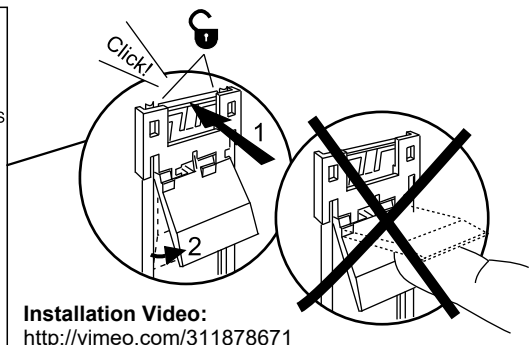
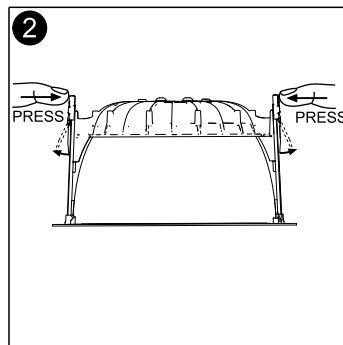

- S** Armaturdel **MÅSTE** anslutas innan nätspänning kopplas in!
- GB** The luminaire **MUST** be connected before plugging in the mains voltage!
- D** Die Leuchtenteil **MUSS** vor dem Einstecken der Netzspannung angeschlossen werden!

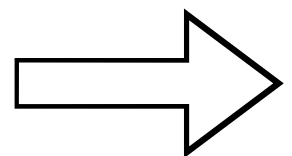
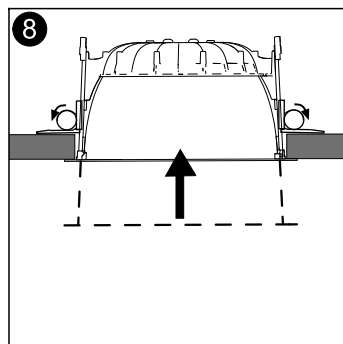
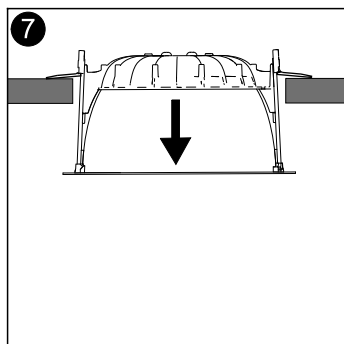

5435812 Utgåva/Edition 02

S Det är lämpligt att denna information överlämnas till användaren av anläggningen.

GB It is appropriate that this information is passed on to the users of the installation.

Manufactured by Fagerhult Sweden.
For UK market importer Fagerhult UK
33-34 Dolben Street, London, SE1 OUG

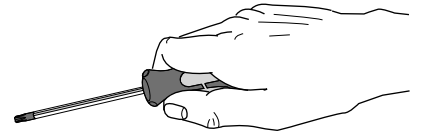

Pleiad G4 Recessed Dim to Warm

Removal Procedure

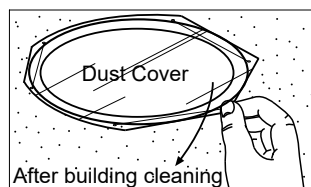
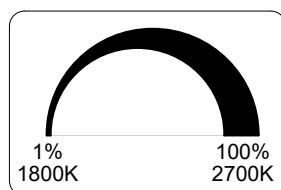
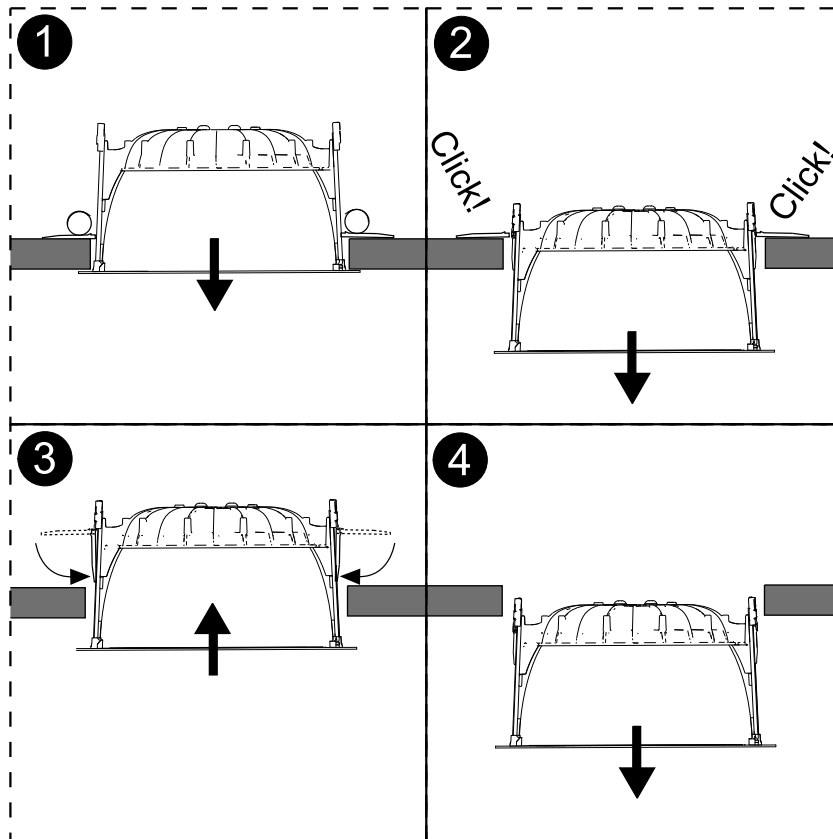

- S** För montering i ventilerat alternativt oventilerat utrymme.
- GB** For mounting in ventilated or unventilated space

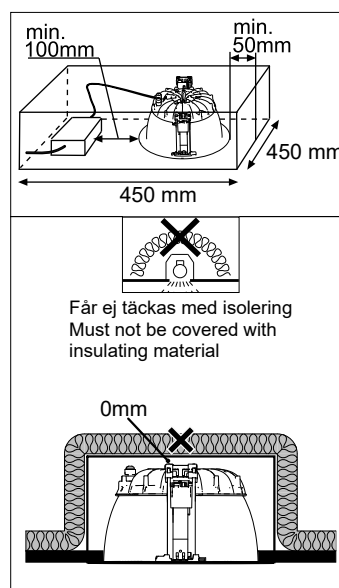

- S** Om armaturens kabel skulle skadas eller om armaturen inte fungerar som den ska, skall dessa komponenter kontrolleras/bytas av tillverkaren eller av tillverkaren utsedd person
- GB** If the luminaire cable is damaged or if the luminaire is not working properly, it shall exclusively be checked/replaced by the manufacturer or by the manufacturer designated person.

- S** Ljuskälla och drivdon ska enbart bytas ut av tillverkaren eller dess utsedda person.
- GB** The light source and control gear shall only be replaced by the manufacturer or its designated person.

FAGERHULT

SE - 566 80 Habo

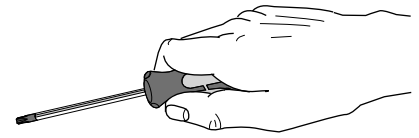

Pleiad G4 70

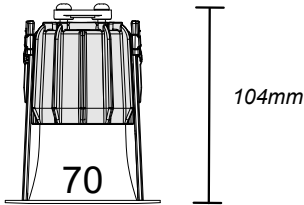

- (S)** Ljuskälla och drivdon ska enbart bytas ut av tillverkaren eller dess utsedda person.
- (GB)** The light source and control gear shall only be replaced by the manufacturer or its designated person.

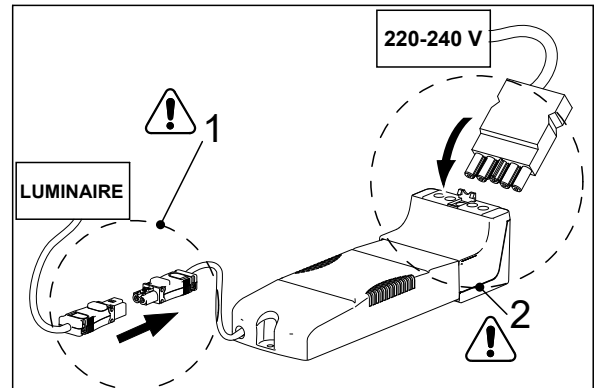

- (S)** Armaturdel MÅSTE anslutas innan nätspänning kopplas in!
- (GB)** The luminaire MUST be connected before plugging in the mains voltage!
- (D)** Die Leuchteile MUSS vor dem Einstecken der Netzspannung angeschlossen werden!

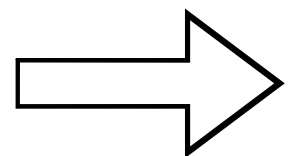
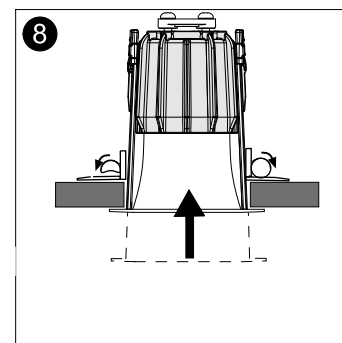
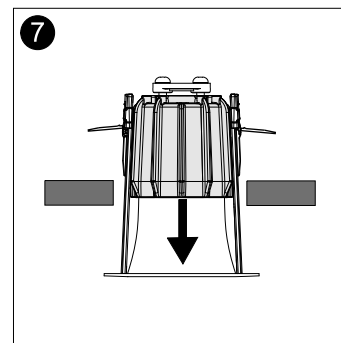
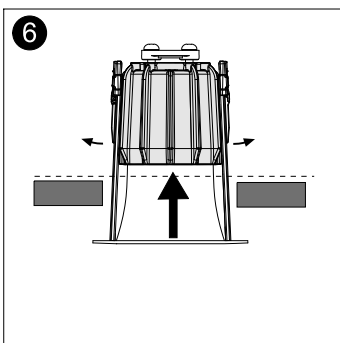
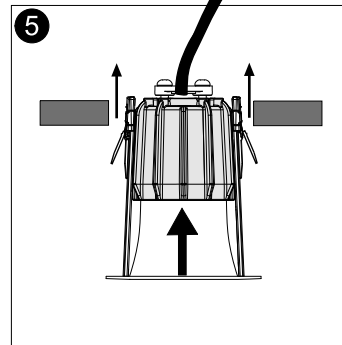
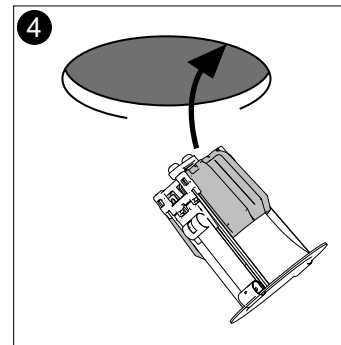
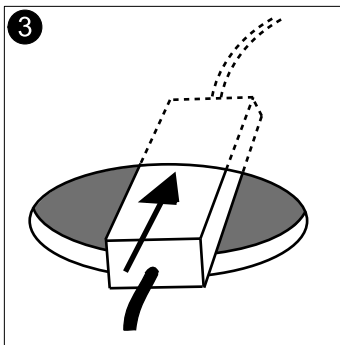
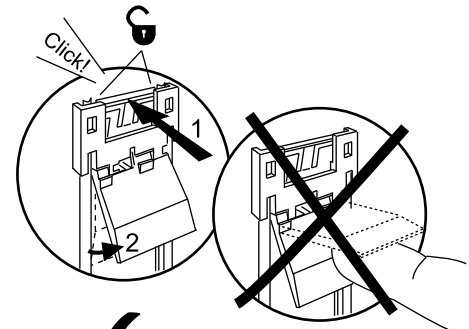
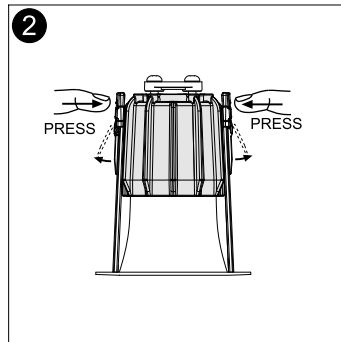
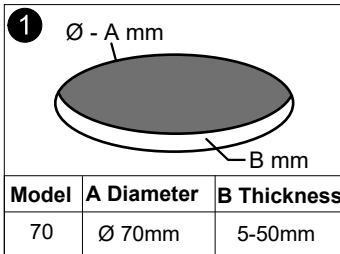

(S) Det är lämpligt att denna information överlämnas till användaren av anläggningen.

(GB) It is appropriate that this information is passed on to the users of the installation.

Manufactured by Fagerhult Sweden.
For UK market importer Fagerhult UK
33-34 Dolben Street, London, SE1 0UQ

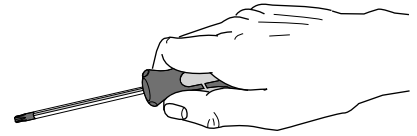

Pleiad G4 70

Remove Procedure

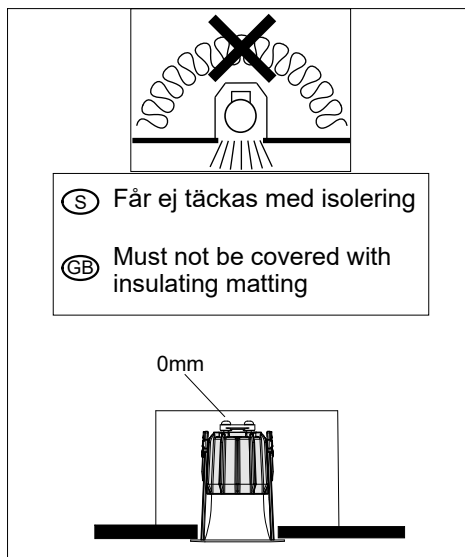
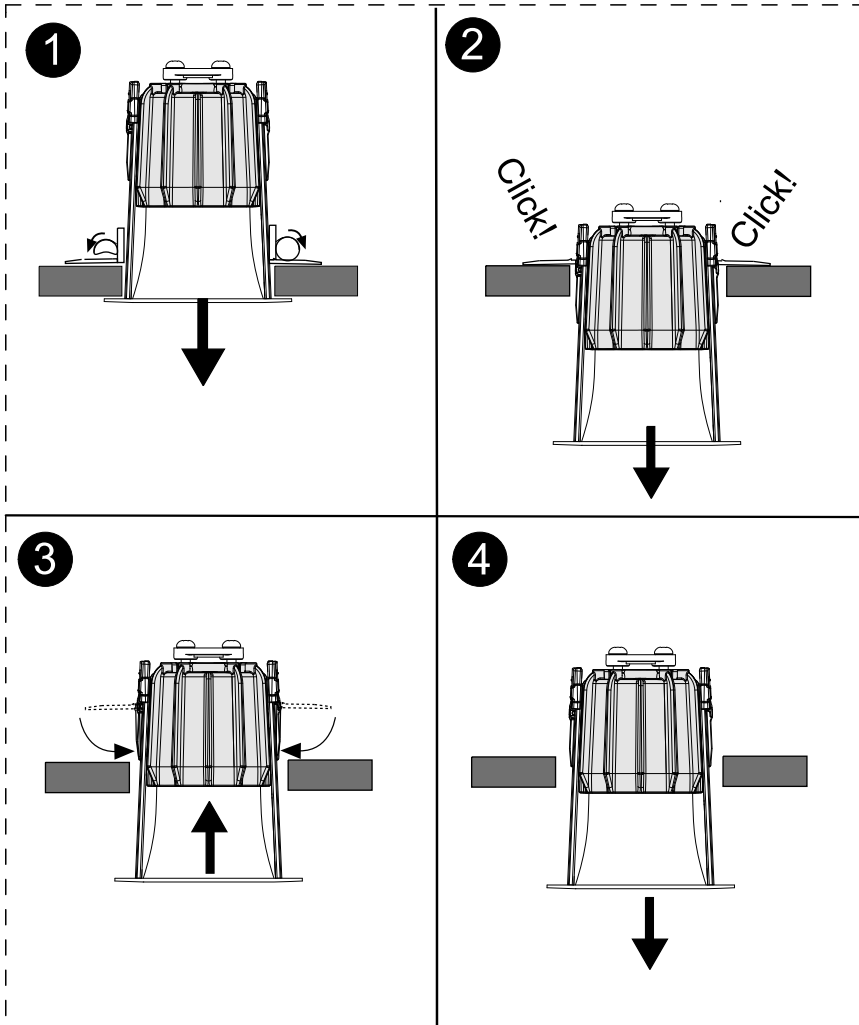

- (S) Om armaturens kabel skulle skadas eller om armaturen inte fungerar som den ska, skall dessa komponenter kontrolleras/bytas av tillverkaren eller av tillverkaren utsedd person
- (GB) If the luminaire cable is damaged or if the luminaire is not working properly, it shall exclusively be checked/replaced by the manufacturer or by the manufacturer designated person.

- (S) Ljuskälla och drivdon ska enbart bytas ut av tillverkaren eller dess utsedda person.
- (GB) The light source and control gear shall only be replaced by the manufacturer or its designated person.

- (S) För montering i ventilerat alternativt oventilerat utrymme.
- (GB) For mounting in ventilated or unventilated space

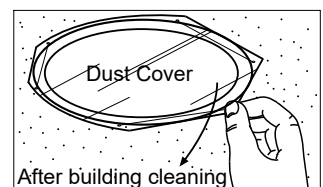
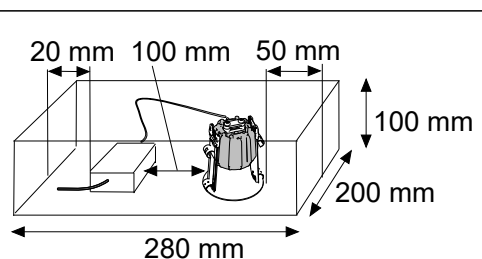

FAGERHULT SE - 566 80 Habo

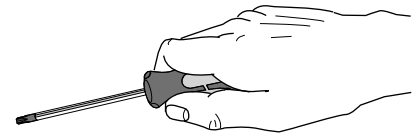

Pleiad G4 70 Dim to Warm

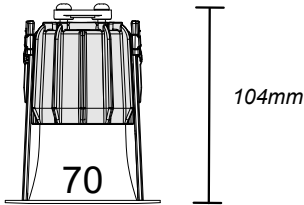

(S) Ljuskälla och drivdon ska enbart bytas ut av tillverkaren eller dess utsedda person.

(GB) The light source and control gear shall only be replaced by the manufacturer or its designated person.

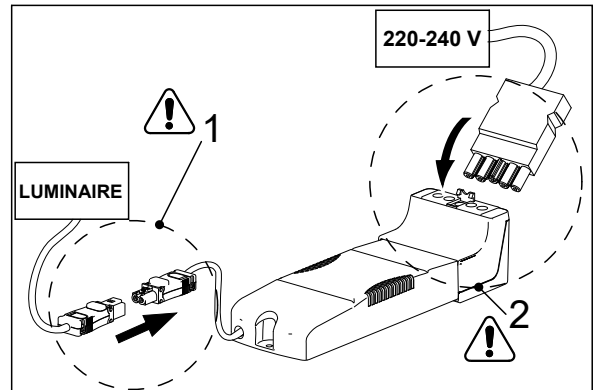

(S) Armaturdel MÅSTE anslutas innan nätspänning kopplas in!

(GB) The luminaire MUST be connected before plugging in the mains voltage!

(D) Die Leuchteile MUSS vor dem Einstecken der Netzspannung angeschlossen werden!

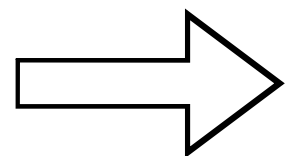
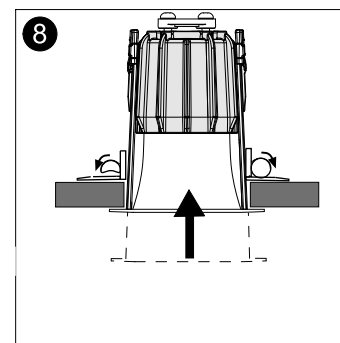
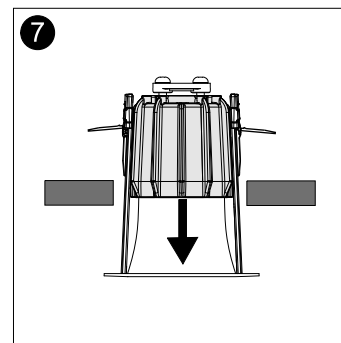
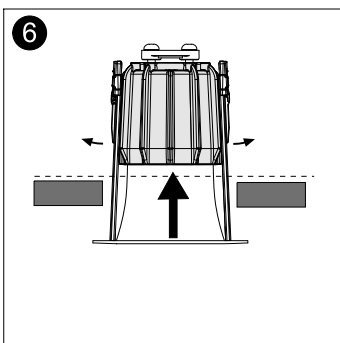
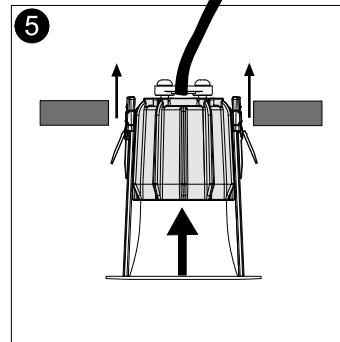
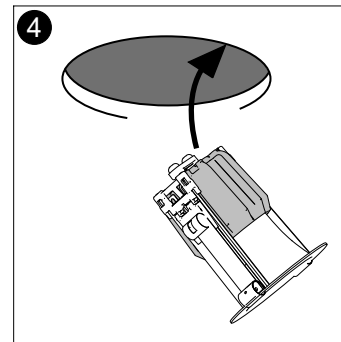
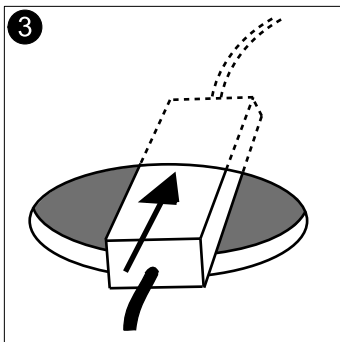
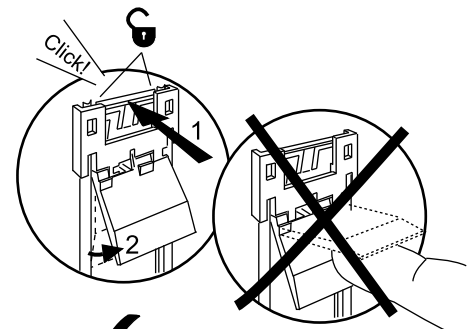
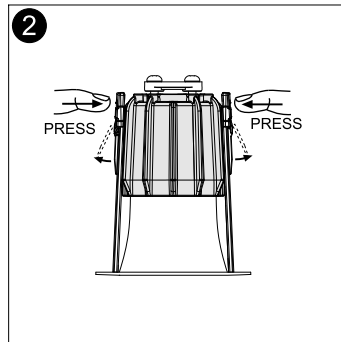
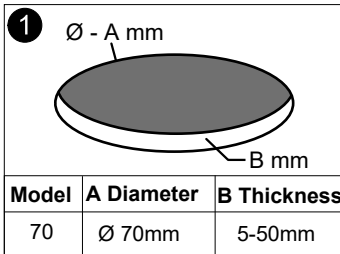

(S) Det är lämpligt att denna information överlämnas till användaren av anläggningen.

(GB) It is appropriate that this information is passed on to the users of the installation.

Manufactured by Fagerhult Sweden.
For UK market importer Fagerhult UK
33-34 Dolben Street, London, SE1 0UQ

FAGERHULT

SE - 566 80 Habo

Pleiad G4 70

Remove Procedure

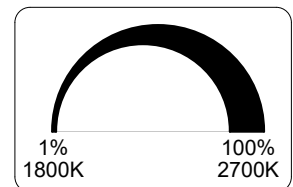
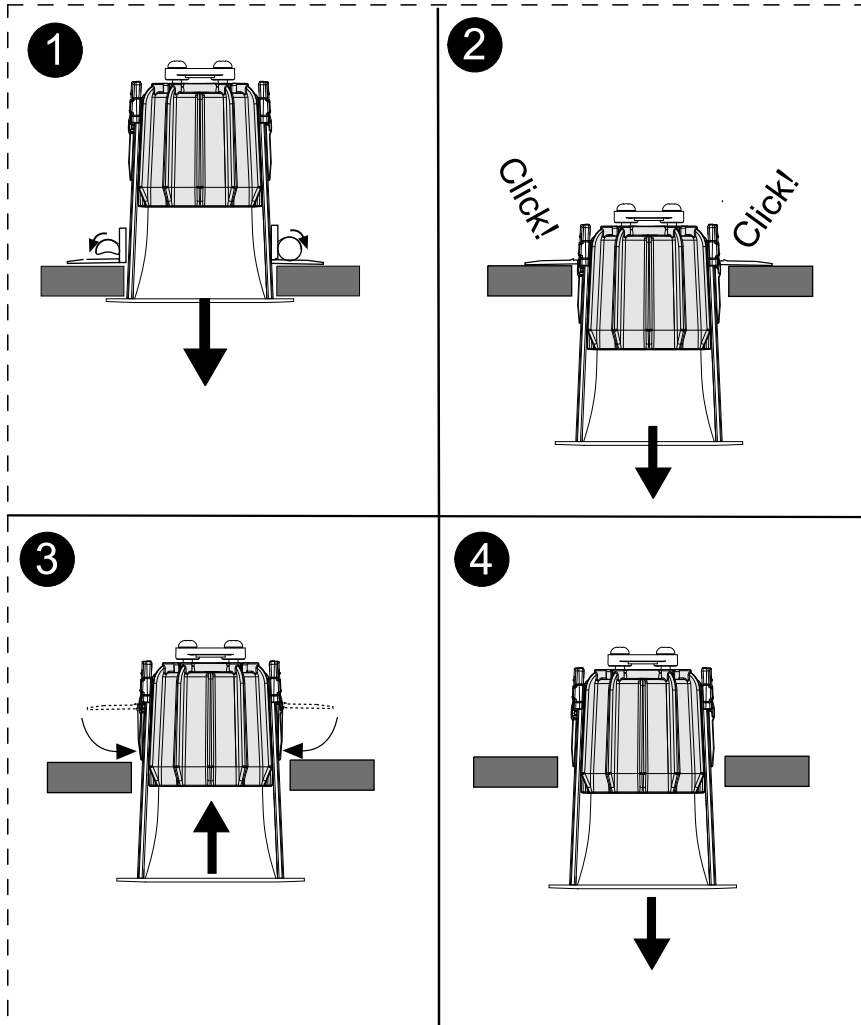
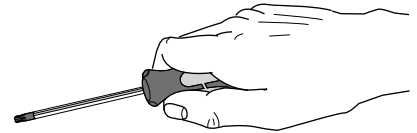

Rikta fjädrar mot väggen
Align the springs towards the wall

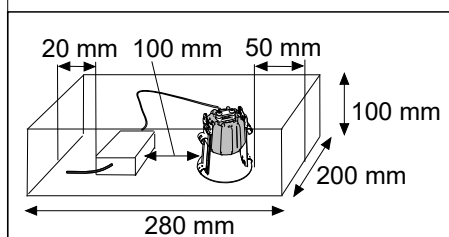
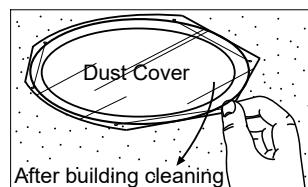
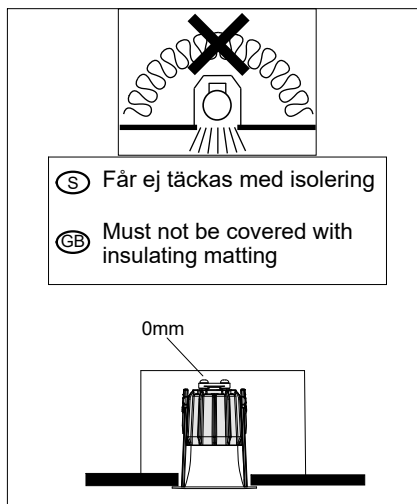
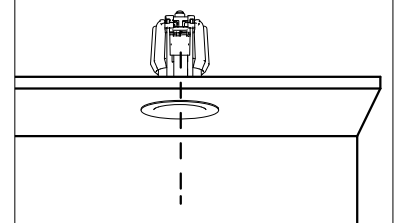

S För montering i ventilerat alternativt oventilerat utrymme.
GB For mounting in ventilated or unventilated space

S Ljuskälla och drivdon ska enbart bytas ut av tillverkaren eller dess utsedda person.
GB The light source and control gear shall only be replaced by the manufacturer or its designated person.

S Om armaturens kabel skulle skadas eller om armaturen inte fungerar som den ska, skall dessa komponenter kontrolleras/bytas av tillverkaren eller av tillverkaren utsedd person
GB If the luminaire cable is damaged or if the luminaire is not working properly, it shall exclusively be checked/replaced by the manufacturer or by the manufacturer designated person.

FAGERHULT

SE - 566 80 Habo

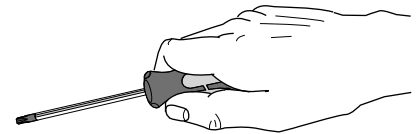

Pleiad G4 70 Recessed Emergency

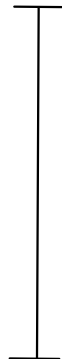
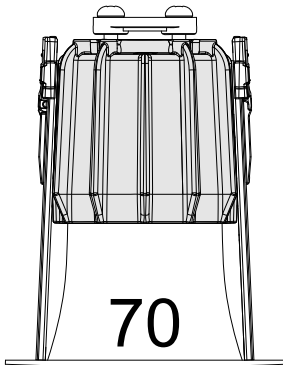

104mm

1 Ø - A mm

B mm

Model	A Diameter	B Thickness
70	Ø 70mm	5-50mm

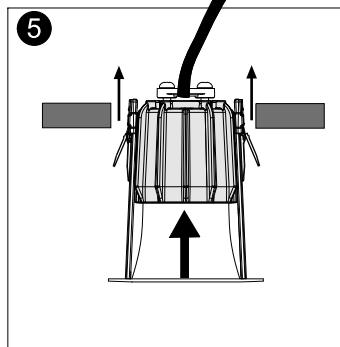
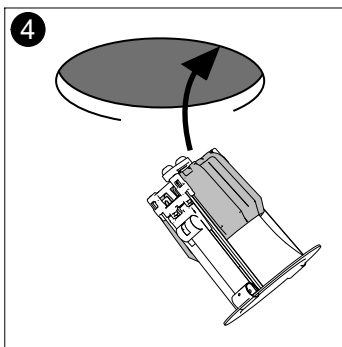
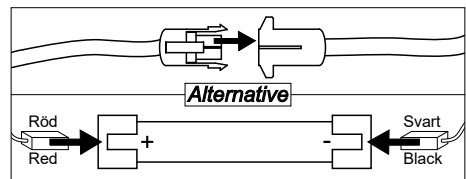
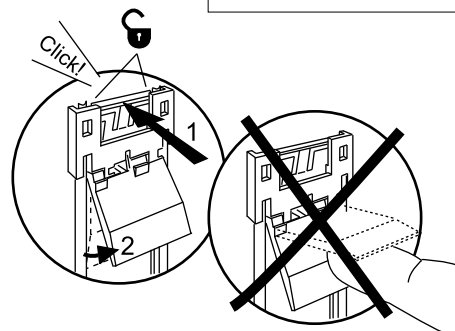
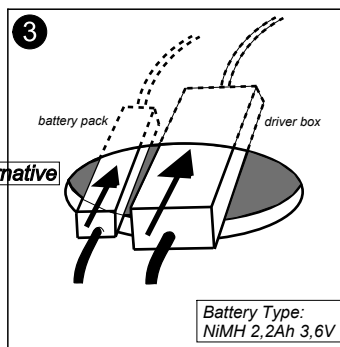
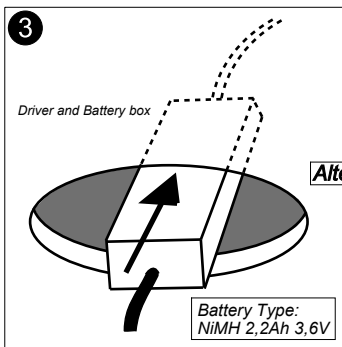
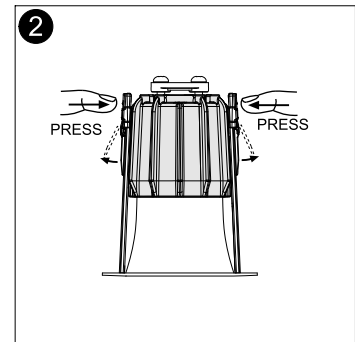

⚡ Bryt spänningen före installation och vid batteribyte
Disconnect luminaire before installation and replacing battery

Anslut batteriet innan spänningen kopplas på.
Connect battery before switching on the main supply

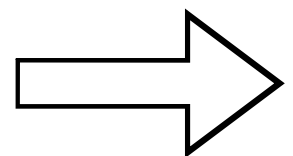
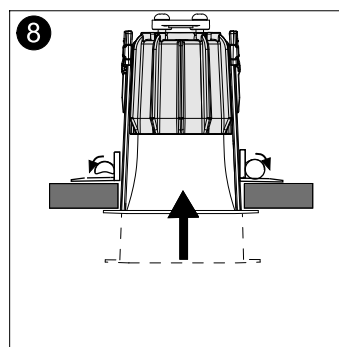
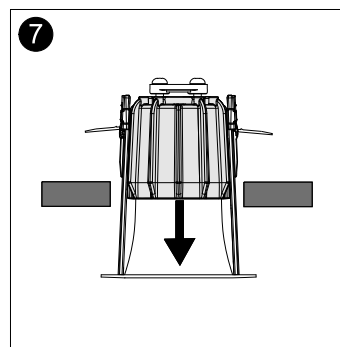
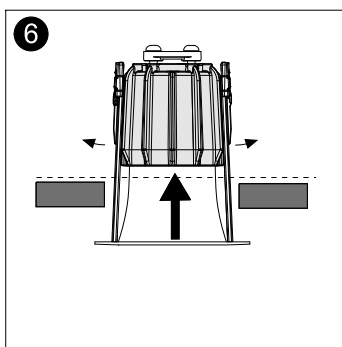

5459178 Utgåva/Edition 02

S Det är lämpligt att denna information överlämnas till användaren av anläggningen.

GB It is appropriate that this information is passed on to the users of the installation.

Manufactured by Fagerhult Sweden.
For UK market importer Fagerhult UK
33-34 Dolben Street, London, SE1 0UQ

FAGERHULT

SE - 566 80 Habo

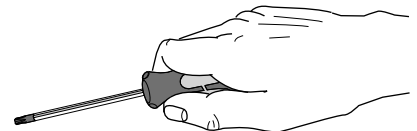

Pleiad G4 70 Recessed Emergency

Removal Procedure

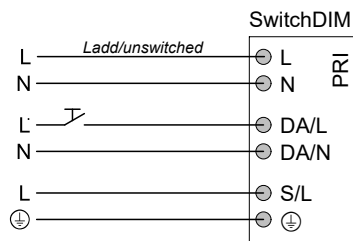
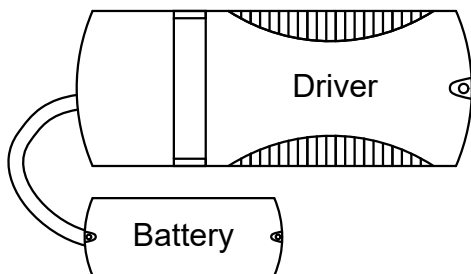
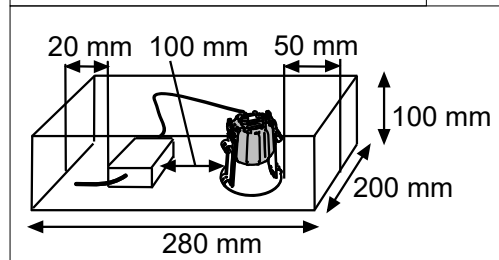
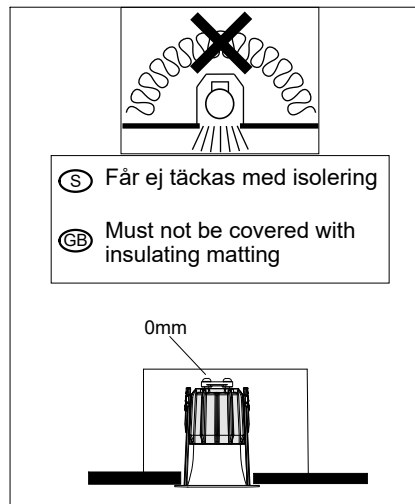
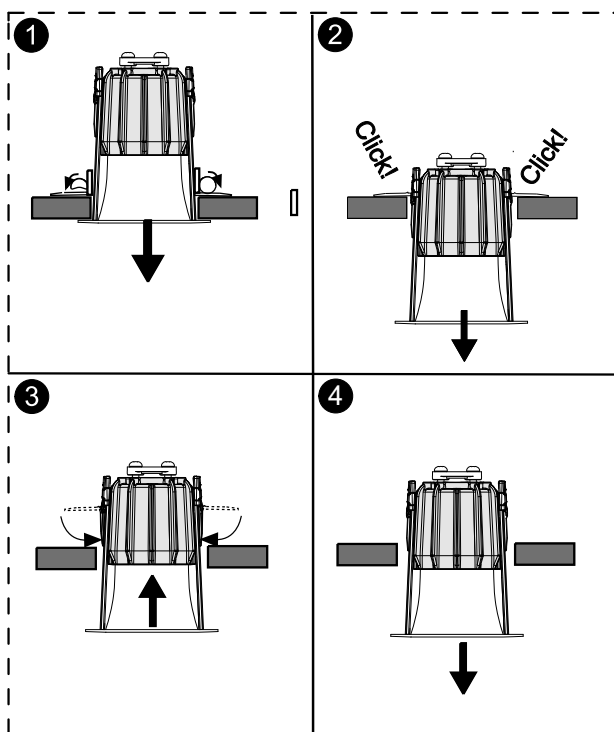

In switchDIM operation the emergency unit will work as SELFTEST unit. All functions and duration tests will perform automatically.

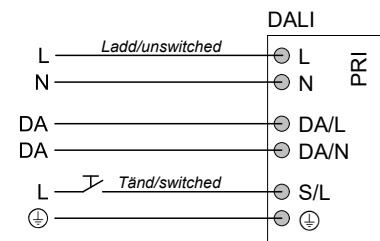

If the optional mains switch is not used connect S/L to L.

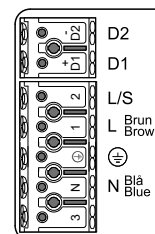
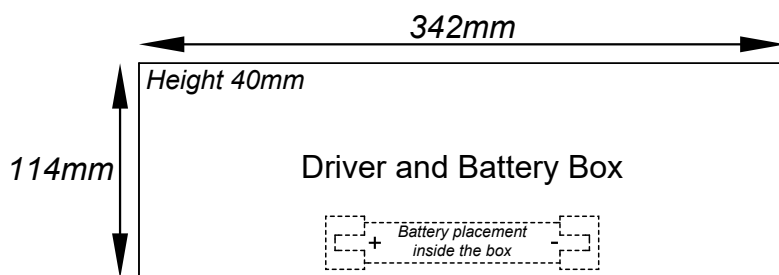

(S) Grundläggande isolering mellan nät och styr ledning.
(GB) Basic insulation between mains and control wiring.



(S) Ljuskälla och drivdon ska enbart bytas ut av tillverkaren eller dess utsedd person.
(GB) The light source and control gear shall only be replaced by the manufacturer or its designated person.

(S) För montering i ventilerat alternativt ventilerat utrymme.
(GB) For mounting in ventilated or unventilated space

(S) Om armaturens kabel skulle skadas eller om armaturen inte fungerar som den ska, skall dessa komponenter kontrolleras/bytas av tillverkaren eller av tillverkaren utsedd person
(GB) If the luminaire cable is damaged or if the luminaire is not working properly, it shall exclusively be checked/replaced by the manufacturer or by the manufacturer designated person.

FAGERHULT

SE - 566 80 Habo

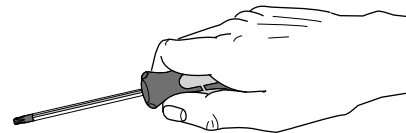

Pleiad G4 Flex

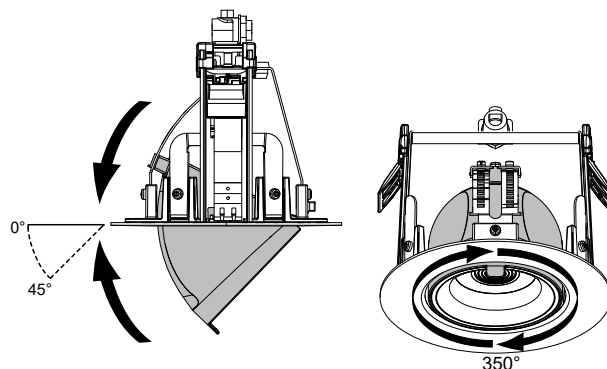
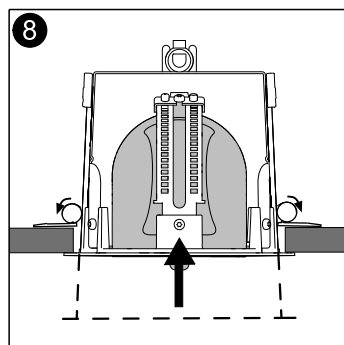
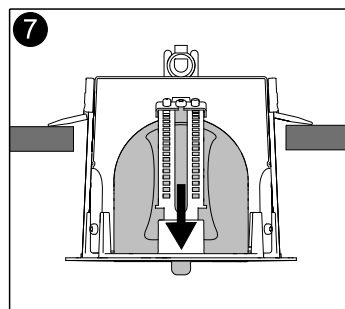
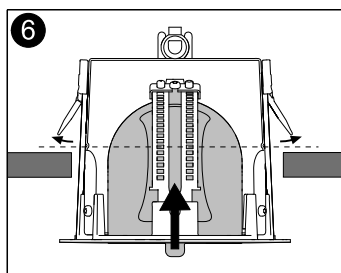
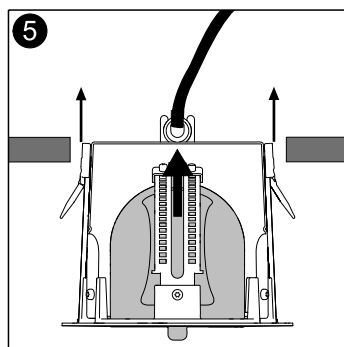
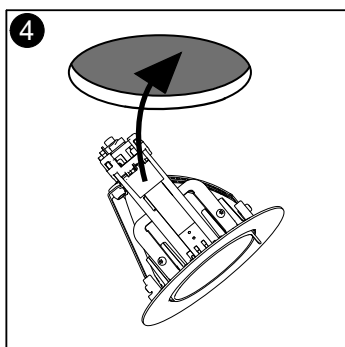
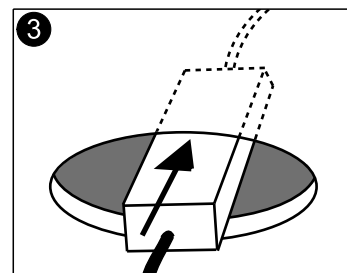
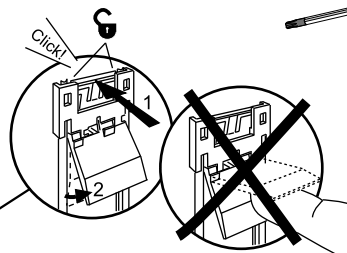
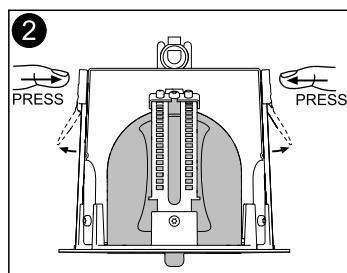
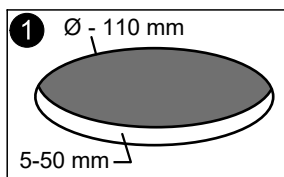

Remove Procedure

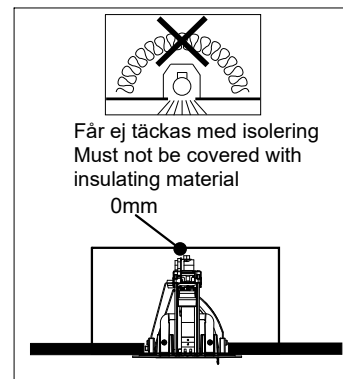
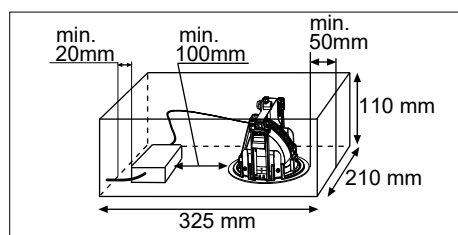
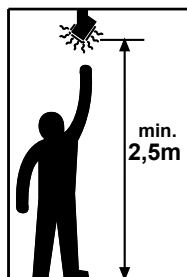
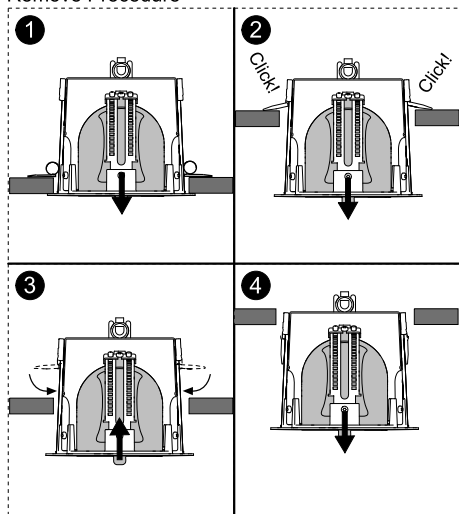

- S** För montering i ventilerat alternativt oventilerat utrymme.
- GB** For mounting in ventilated or unventilated space

Manufactured by Fagerhult Sweden.
For UK market importer Fagerhult UK
33-34 Dolben Street, London, SE1 OUQ

S Det är lämpligt att denna information överlämnas till användaren av anläggningen.

GB It is appropriate that this information is passed on to the users of the installation.

S Ljuskälla, drivdon och anslutningskabel ska enbart bytas ut av tillverkaren eller dess utsedda person.

GB The light source, control gear and external cable shall exclusively be replaced by the manufacturer or its designated person.

FAGERHULT SE - 566 80 Habo

Pleiad G4 Flex Dim to Warm

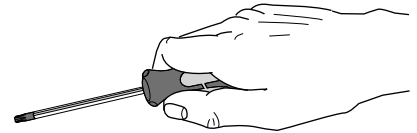

(S) Ljuskälla och drivdon ska enbart bytas ut av tillverkaren eller dess utsedda person.
(GB) The light source and control gear shall only be replaced by the manufacturer or its designated person.

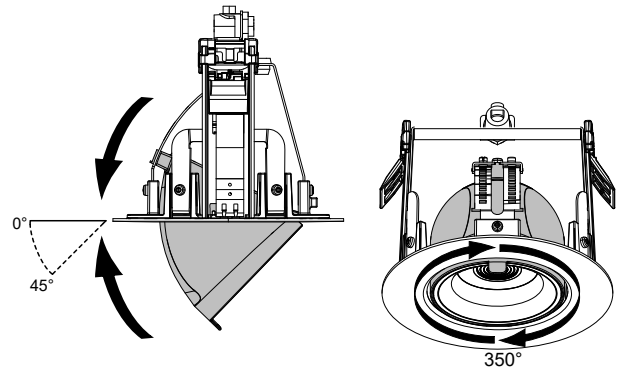
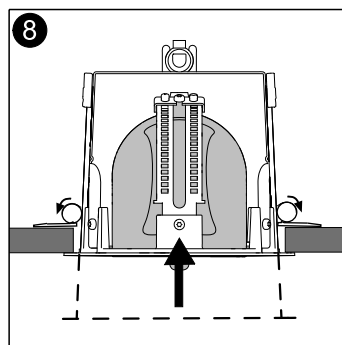
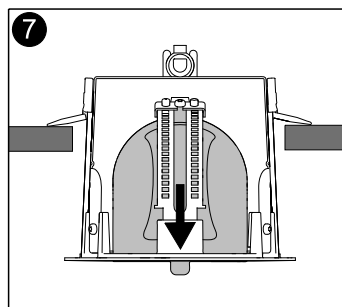
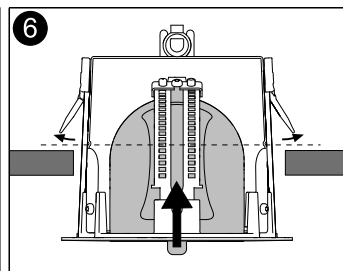
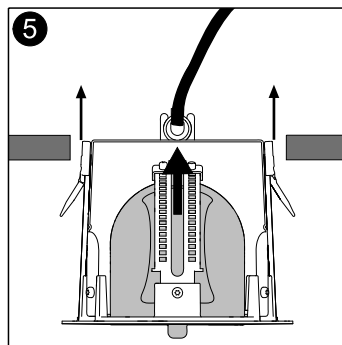
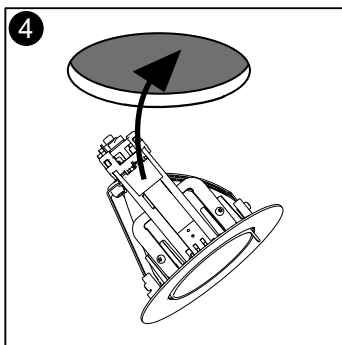
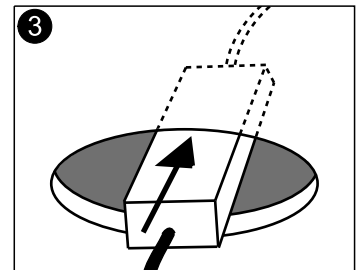
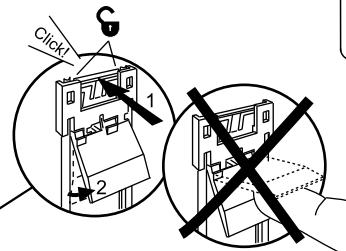
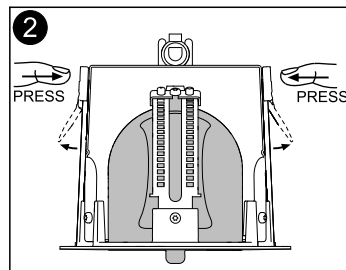
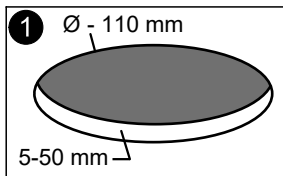

(S) För montering i ventilerat alternativt oventilerat utrymme.
(GB) For mounting in ventilated or unventilated space

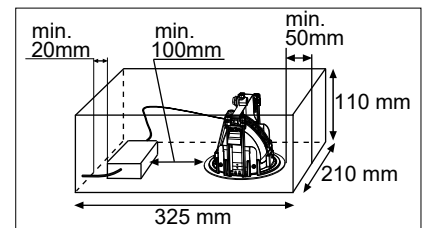

Remove Procedure

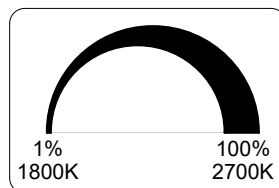
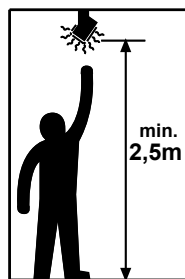
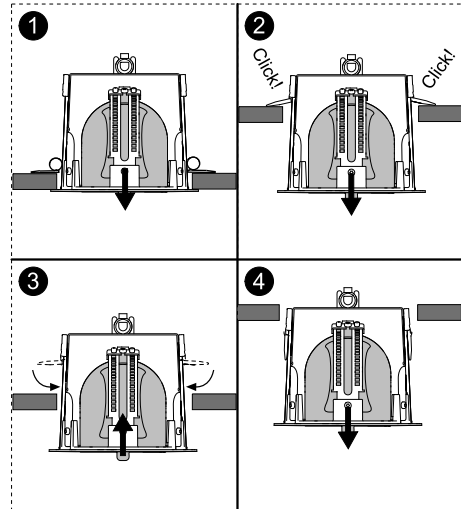

(S) Ljuskälla, drivdon och anslutningskabel ska enbart bytas ut av tillverkaren eller dess utsedda person.
(GB) The light source, control gear and external cable shall exclusively be replaced by the manufacturer or its designated person.

(S) Får ej täckas med isolering
(GB) Must not be covered with insulating matting

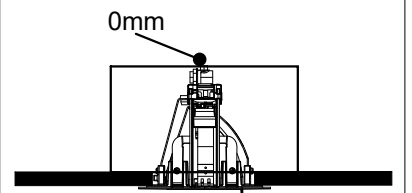

Manufactured by Fagerhult Sweden.
 For UK market importer Fagerhult UK
 33-34 Dolben Street, London, SE1 0UQ

(S) Det är lämpligt att denna information överlämnas till användaren av anläggningen. **(GB)** It is appropriate that this information is passed on to the users of the installation.

FAGERHULT SE - 566 80 Habo

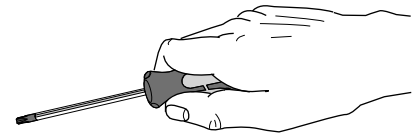

Pleiad G4 Wallwasher

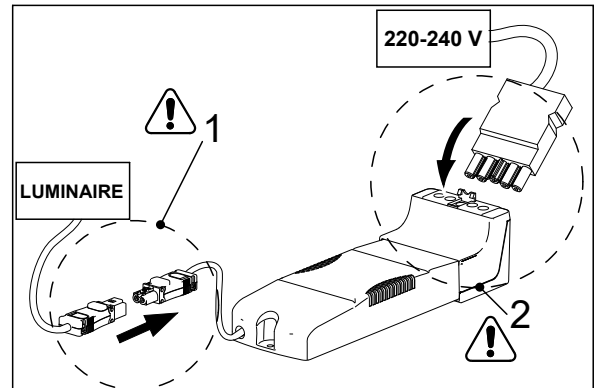
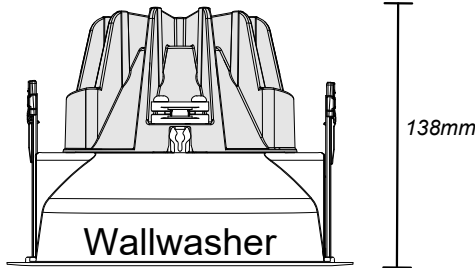

- (S)** Armaturdel MÅSTE anslutas innan nätspänning kopplas in!
- (GB)** The luminaire **MUST** be connected before plugging in the mains voltage!
- (D)** Die Leuchteil **MUSS** vor dem Einstecken der Netzspannung angeschlossen werden!

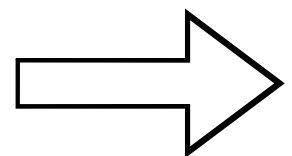
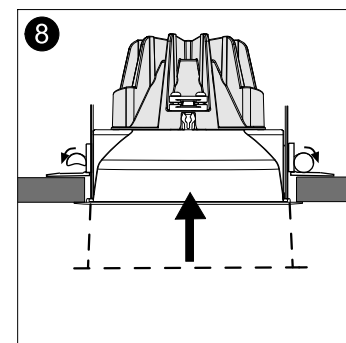
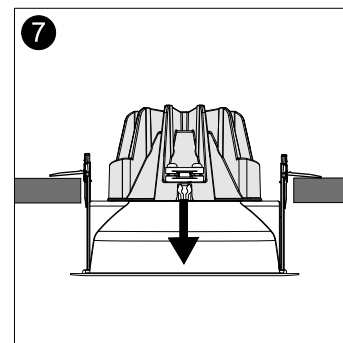
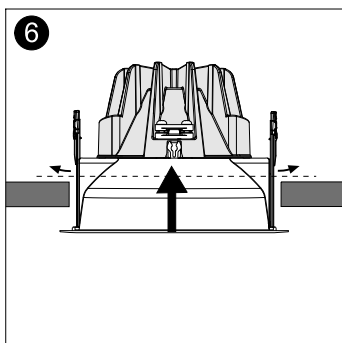
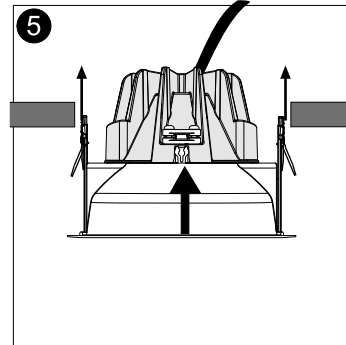
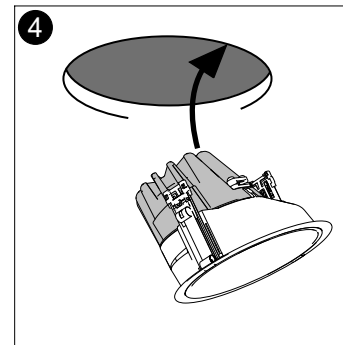
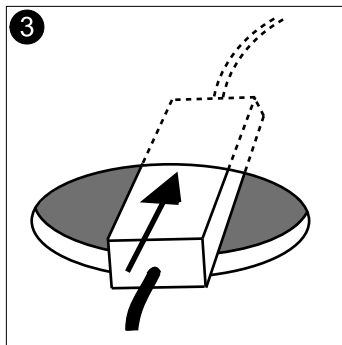
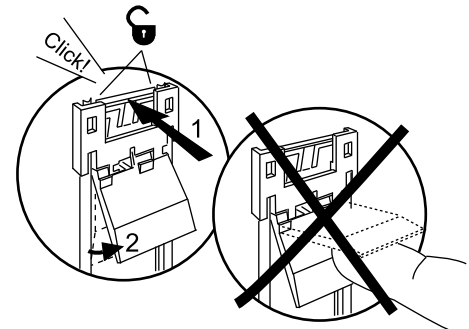
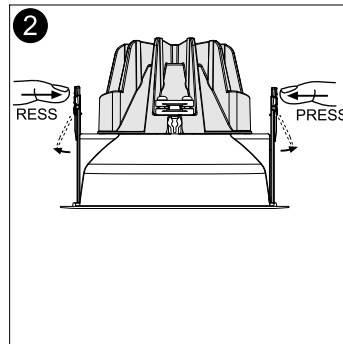
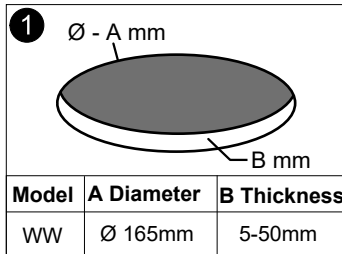

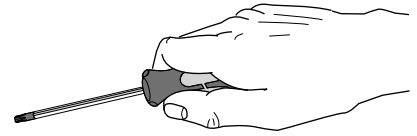

Pleiad G4 Wallwasher

Remove Procedure

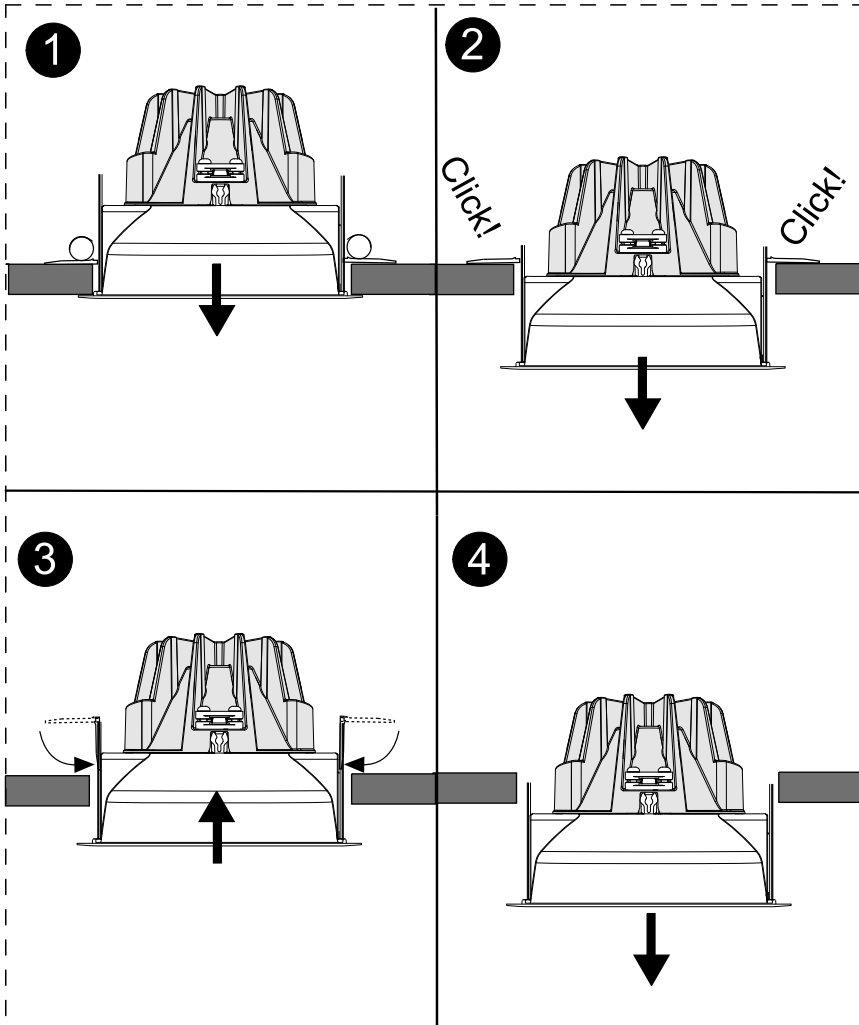

- (S)** Ljuskälla och drivdon ska enbart bytas ut av tillverkaren eller dess utsedda person.
- (GB)** The light source and control gear shall only be replaced by the manufacturer or its designated person.

- (S)** Om armaturens kabel skulle skadas eller om armaturen inte fungerar som den ska, skall dessa komponenter kontrolleras/bytas av tillverkaren eller av tillverkaren utsedd person
- (GB)** If the luminaire cable is damaged or if the luminaire is not working properly, it shall exclusively be checked/replaced by the manufacturer or by the manufacturer designated person.

min. 100mm		min. 50mm		450 mm	
<p>Får ej täckas med isolering Must not be covered with insulating material</p> <p>0mm</p>		<p>Får ej täckas med isolering Must not be covered with insulating material</p> <p>60mm</p>		<p>Får täckas med isolering enligt tabell nedan May be covered with insulating material according to table below</p> <p>0mm</p>	
Model	Constant Current Max	Model	Constant Current Max	Model	Constant Current
WW	450mA	WW	650mA	WW	≤400mA

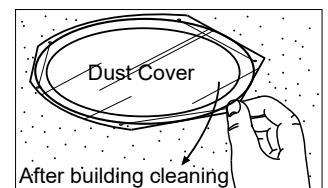

- (S)** För montering i ventilerat alternativt oventilerat utrymme.
- (GB)** For mounting in ventilated or unventilated space

FAGERHULT SE - 566 80 Habo

Pleiad G4 Wallwasher TW

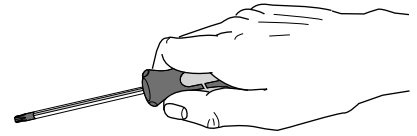

Installation Video:
<http://vimeo.com/311878671>

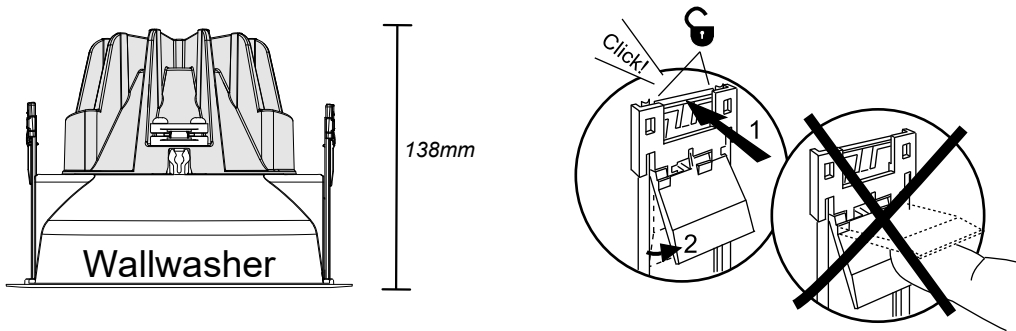

1 Ø - A mm
 B mm

Model	A Diameter	B Thickness
WW	Ø 165mm	5-50mm

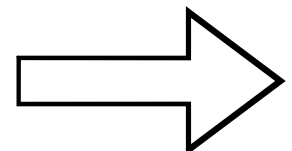
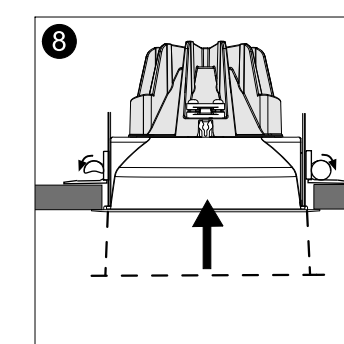
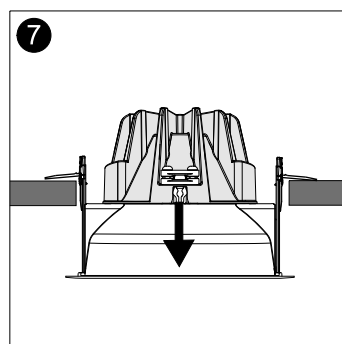
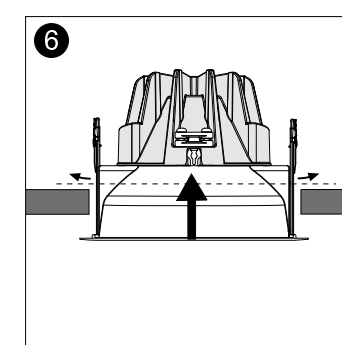
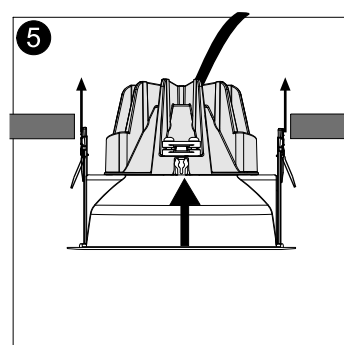
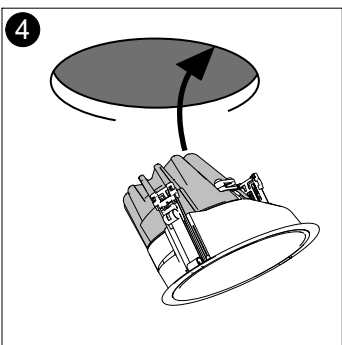
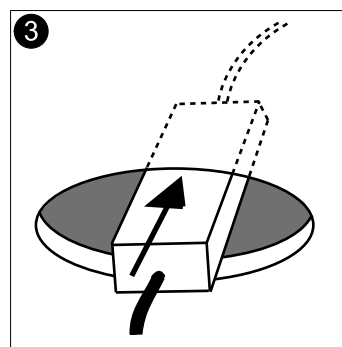
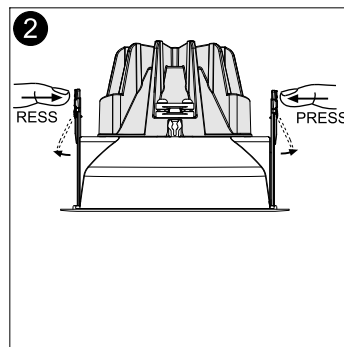

5425035 Utgåva/Edition 03

S Det är lämpligt att denna information överlämnas till användaren av anläggningen. **GB** It is appropriate that this information is passed on yhe users of the installation. **Manufactured by Fagerhult Sweden. For UK market importer Fagerhult UK 33-34 Dolben Street, London, SE1 OUK**

FAGERHULT

SE - 566 80 Habo

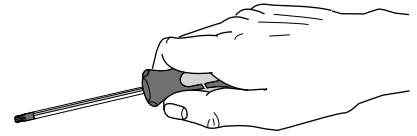

Remove Procedure

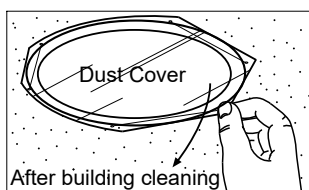
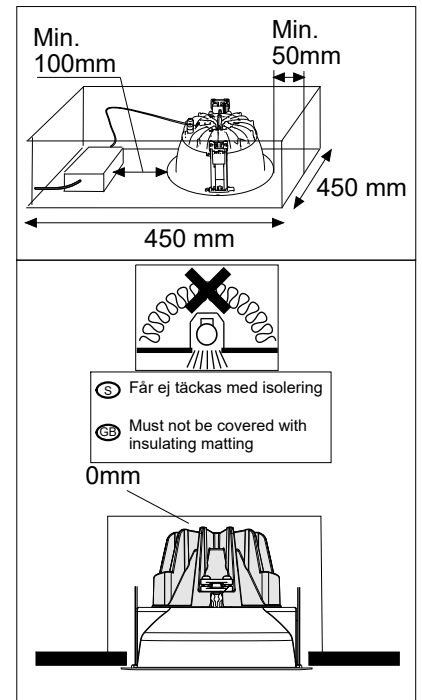
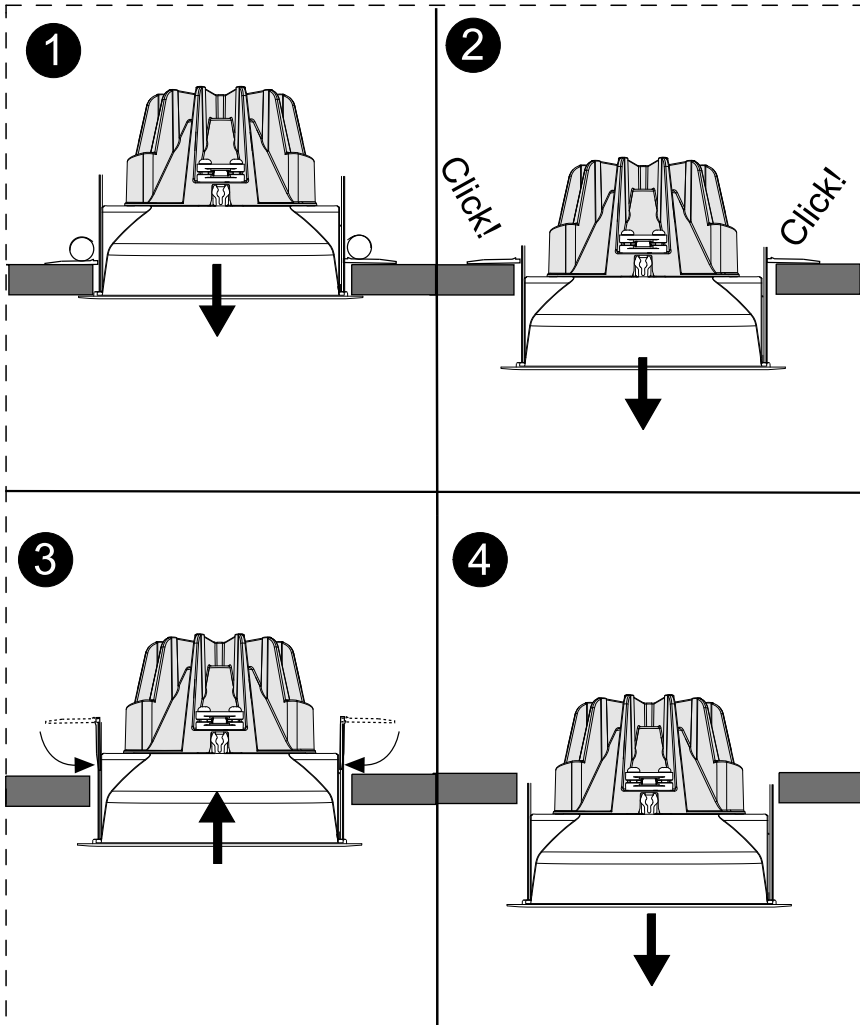

After building cleaning

(S) Grundläggande isolering mellan nät och styr ledning.

(GB) Basic insulation between mains and control wiring.

colourSWITCH/switchDIM

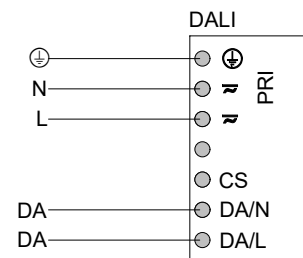
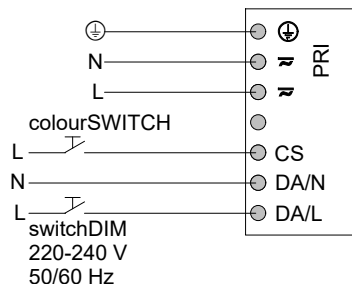

(S) Ljuskälla och drivdon ska enbart bytas ut av tillverkaren eller dess utsedda person.

(GB) The light source and control gear shall only be replaced by the manufacturer or its designated person.

(S) För montering i ventilerat alternativt oventilerat utrymme.

(GB) For mounting in ventilated or unventilated space

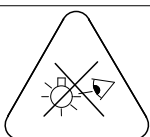

(S) Armaturen bör placeras så att långvarigt tittande direkt in i armaturen inte förväntas på ett avstånd närmre än 0,5m.

(GB) The luminaire should be positioned so that prolonged staring into the luminaire at a distance closer than 0,5m is not expected.

(S) Om armaturens kabel skulle skadas eller om armaturen inte fungerar som den ska, skall dessa komponenter kontrolleras/bytas av tillverkaren eller av tillverkaren utsedd person

(GB) If the luminaire cable is damaged or if the luminaire is not working properly, it shall exclusively be checked/replaced by the manufacturer or by the manufacturer designated person.