

# FAGERHULT

SE - 566 80 Habo

## NOTOR G2 RELIGHT COVER PLATE

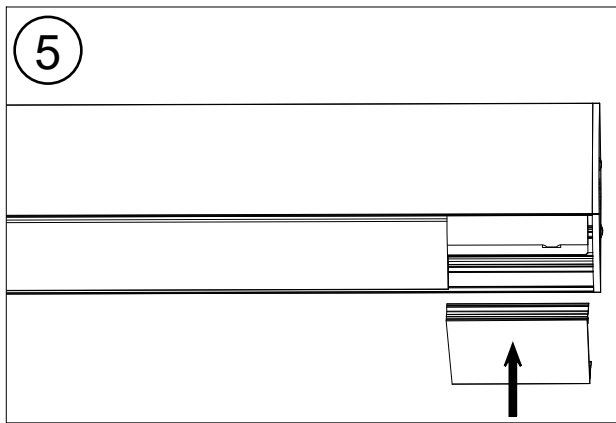
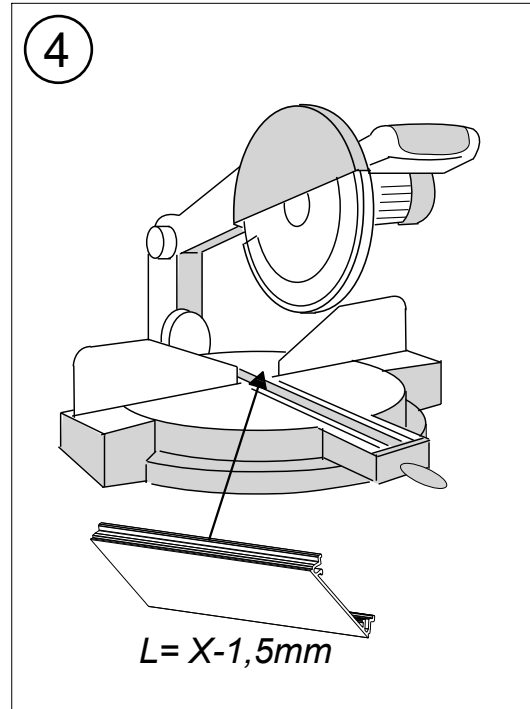
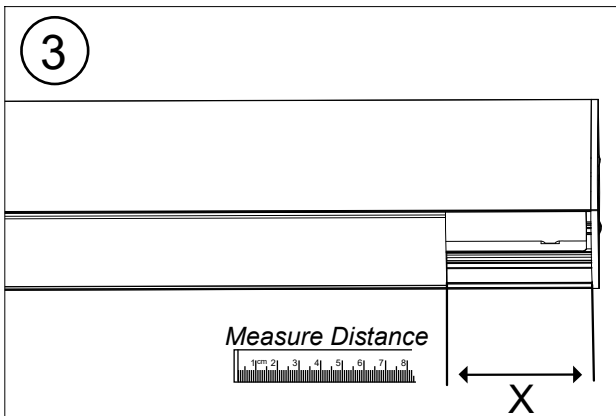
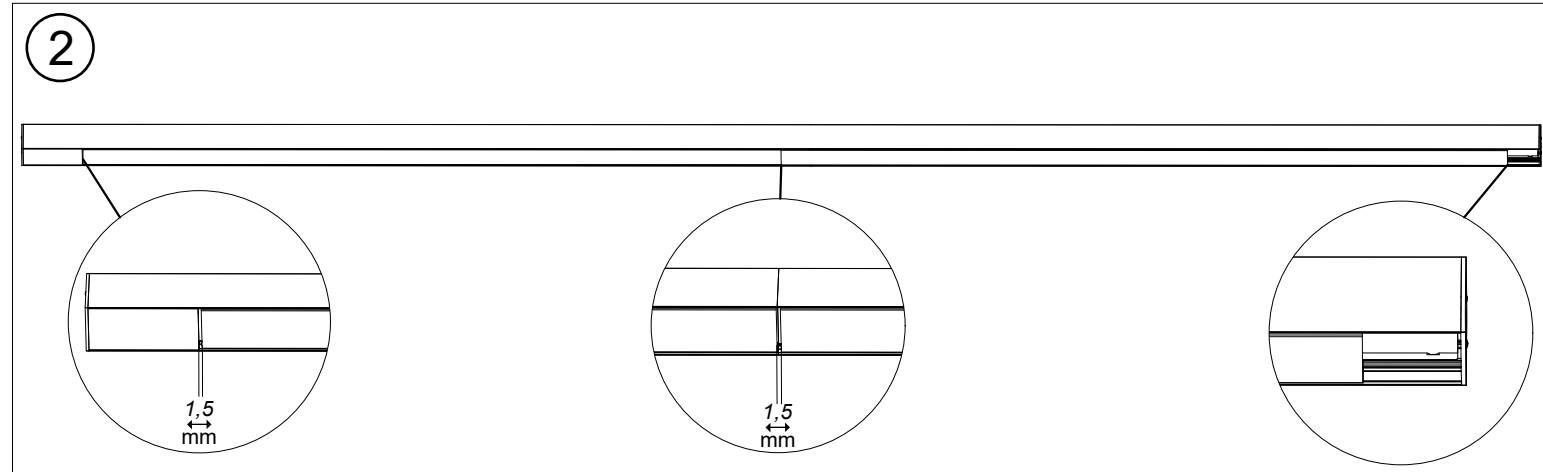
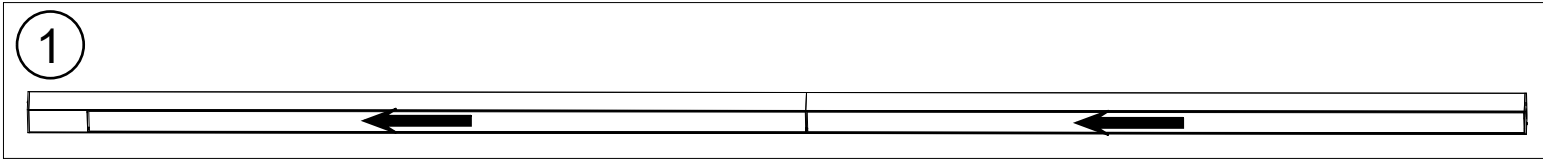
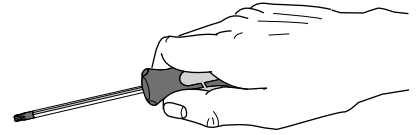

5466839 Utgåva/Edition 01

(S) Det är lämpligt att denna information överlämnas till användaren av anläggningen. (GB) It is appropriate that this information is passed on to the users of the installation.

Manufactured by Fagerhult  
For UK market importer Fagerhult UK  
33-34 Dolben Street, London, SE1 OUK

# FAGERHULT SE - 566 80 Habo

## Notor G2 ReLight Continuous

Demontering av gamla lysrörskomponenter  
Disassembly of old fluorescent tube components



New Opal  
Order-nr  
L=1200: 96500  
L=1500: 96501  
L= 900: 96499  
Note: New lamell louvre is not available

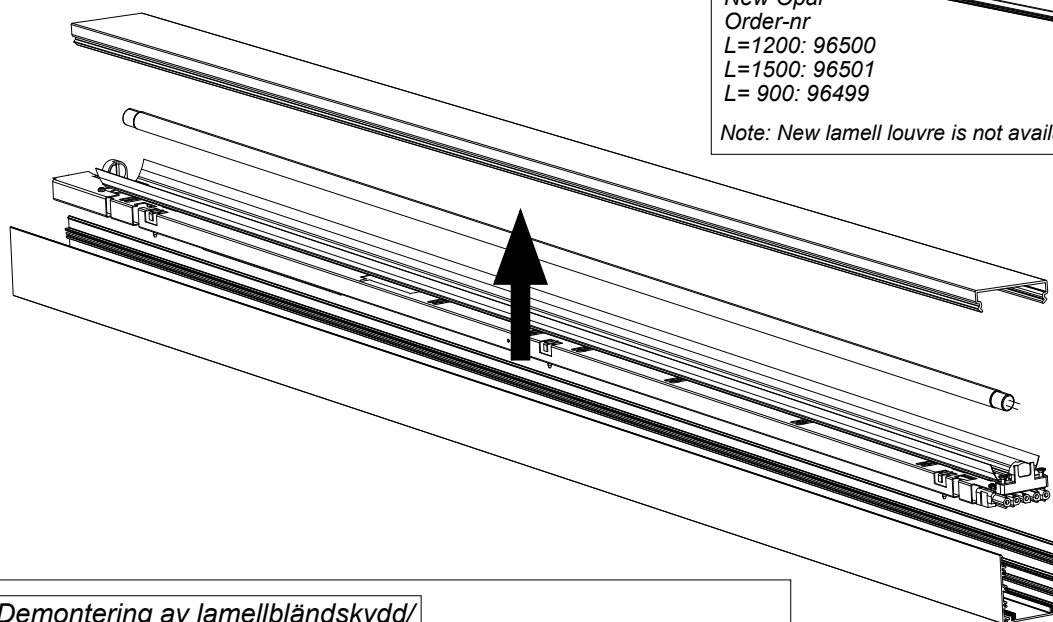
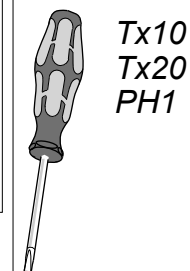

Demontering av lamellbländskydd/  
Disassemble lamell louvre

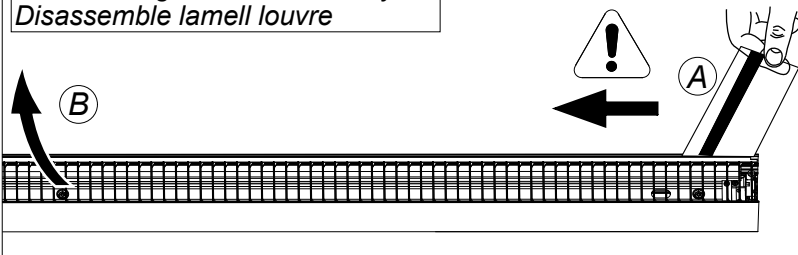

Komponenter till återvinning/  
Components to recycling

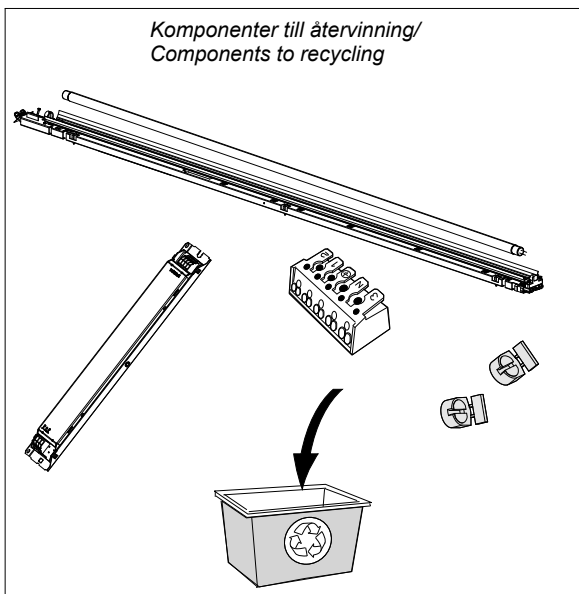

Komponenter att behålla/  
Components to keep

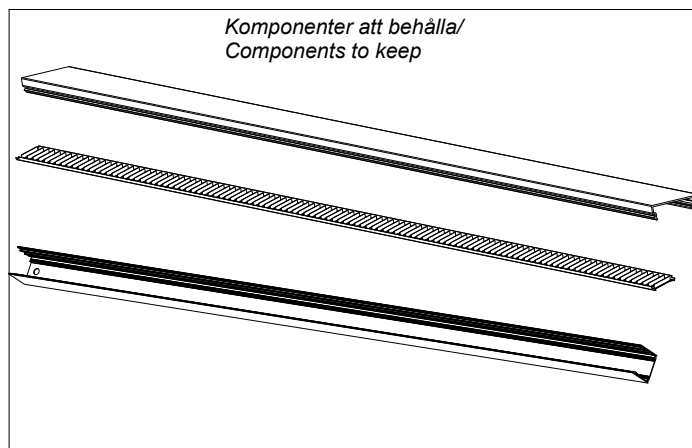

**(S)** Denna produkt innehåller en ljuskälla med energieffektivitets klass C

**(GB)** This product contains a light source of energyefficiency class C

**(S)** Ljuskälla och drivdon ska enbart bytas ut av tillverkaren eller dess utsedda person.

**(GB)** The light source and control gear shall only be replaced by the manufacturer or its designated person.

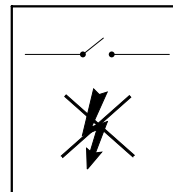

Bryt spänningen före installation och vid sensorinställningar

Disconnect luminaire before installation and change of sensor settings



**(S)** Det är lämpligt att denna information överlämnas till användaren av anläggningen.

**(GB)** It is appropriate that this information is passed on to the users of the installation.

Manufactured by Fagerhult  
For UK market importer Fagerhult UK  
33-34 Dolben Street, London, SE1 OUK

# FAGERHULT

SE - 566 80 Habo

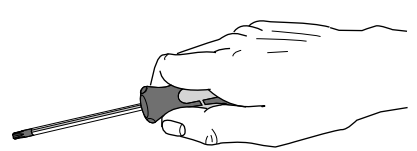

## Notor G2 ReLight Continuous Montering/Assembly

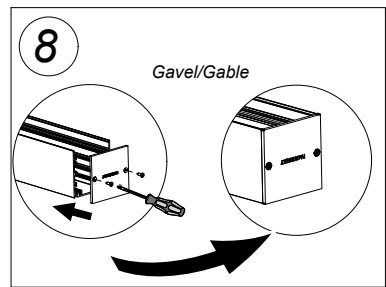
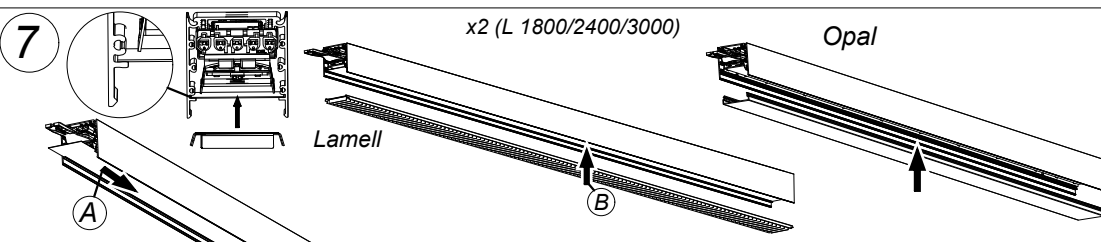
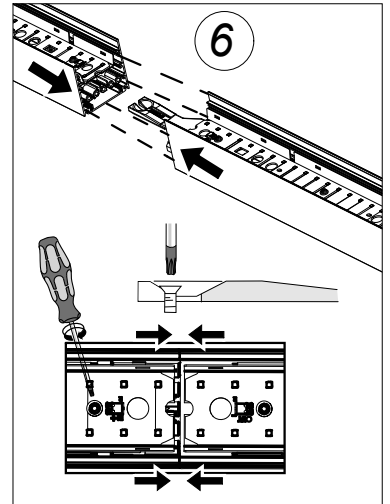
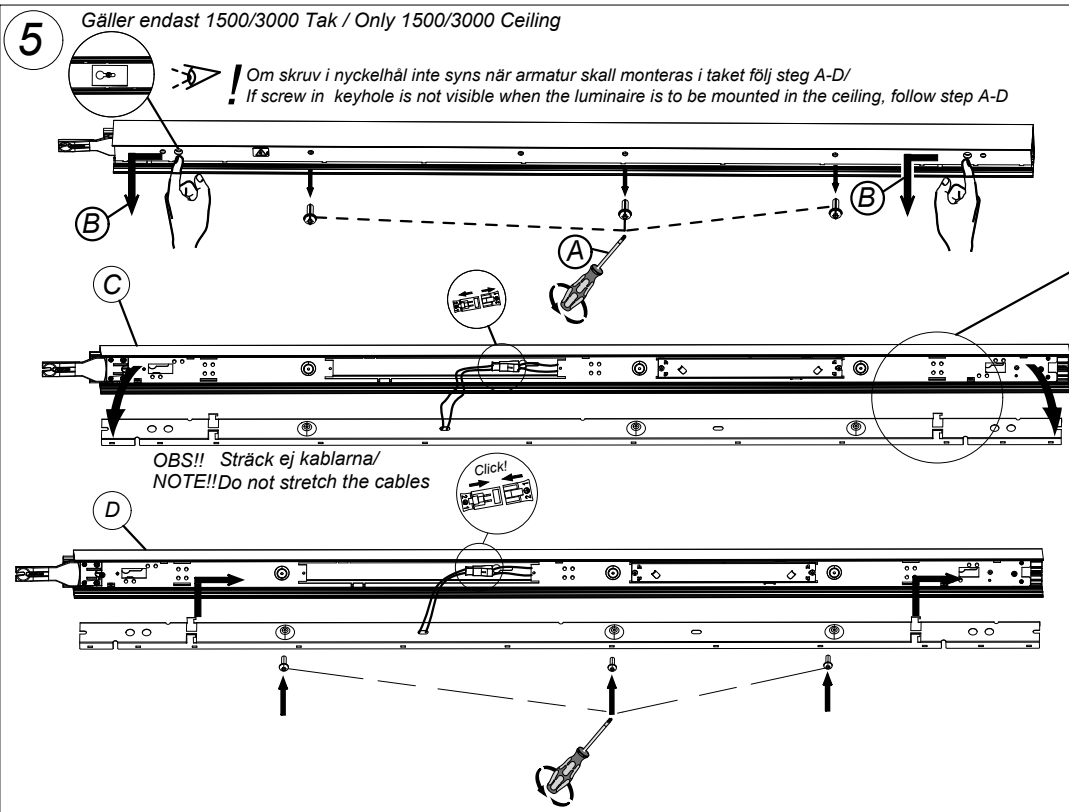
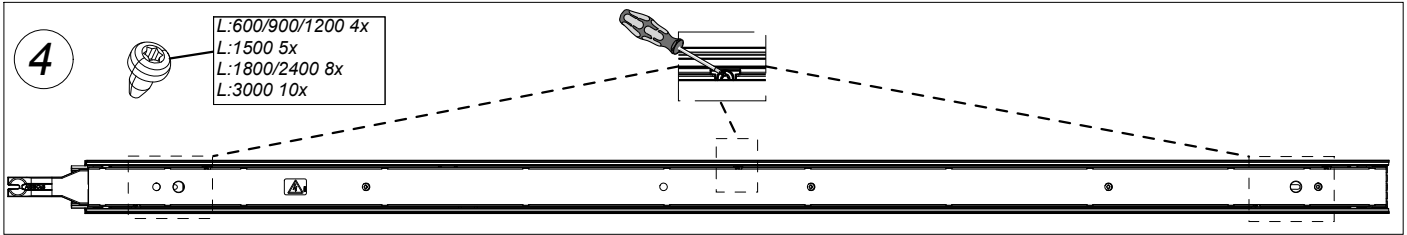
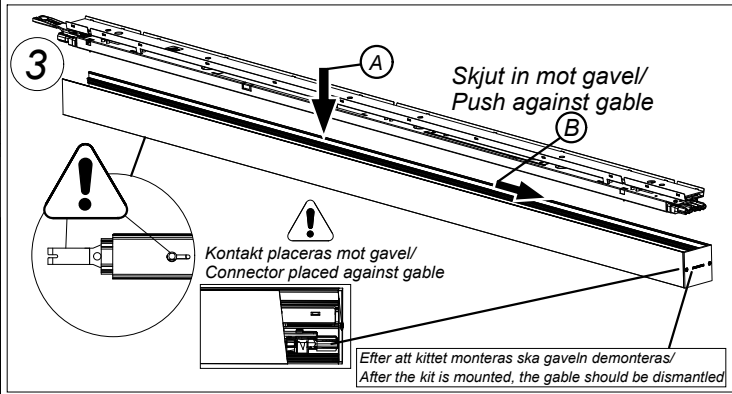
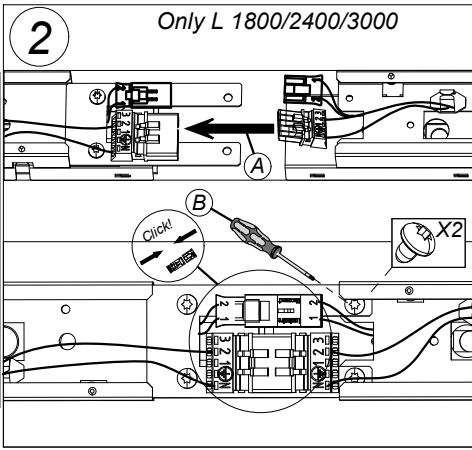
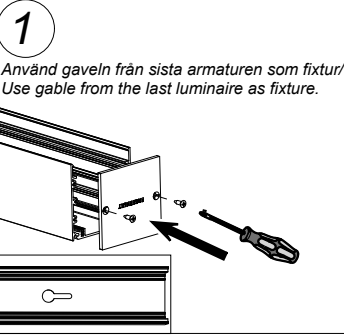

Blank sida mot LED/  
Glossy side against LED

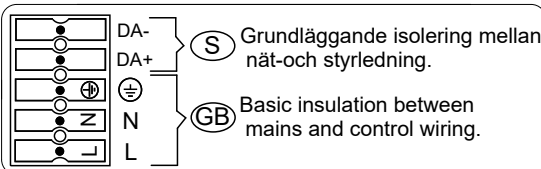

Manufactured by Fagerhult  
For UK market importer Fagerhult UK  
33-34 Dolben Street, London, SE1 0UQ

(S) Det är lämpligt att denna information överlämnas till användaren av anläggningen.

(GB) It is appropriate that this information is passed on to the users of the installation.

# FAGERHULT

SE - 566 80 Habo

## Notor G2 ReLight Organic Response



Demontering av gamla lysrörskomponenter  
Disassembly of old fluorescent tube components

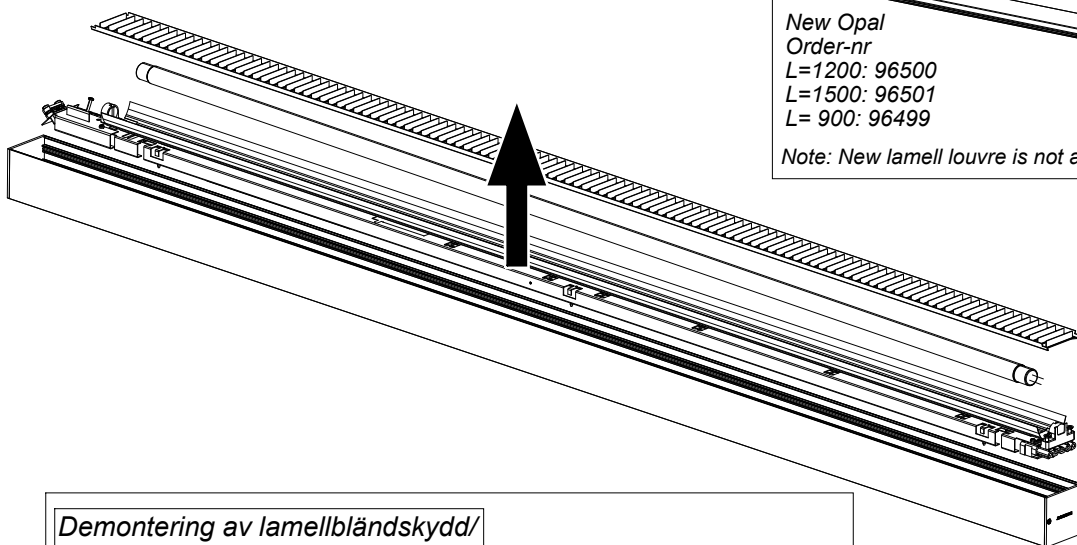

New Opal  
Order-nr  
L=1200: 96500  
L=1500: 96501  
L= 900: 96499

Note: New lamell louvre is not available

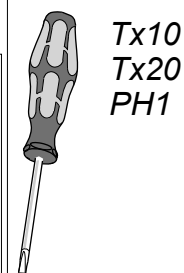

Tx10  
Tx20  
PH1

Demontering av lamellbländskydd/  
Disassemble lamell louvre

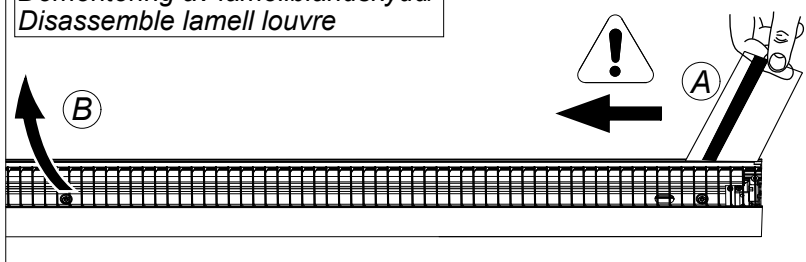

Komponenter till återvinning/  
Components to recycling

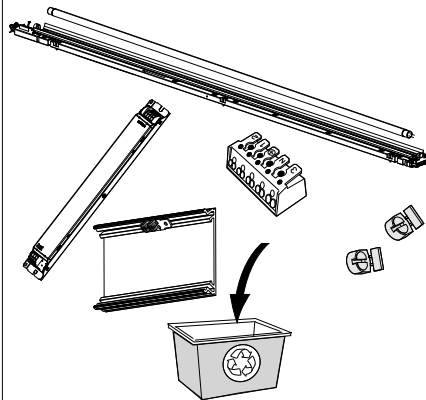

Komponenter att behålla/  
Components to keep

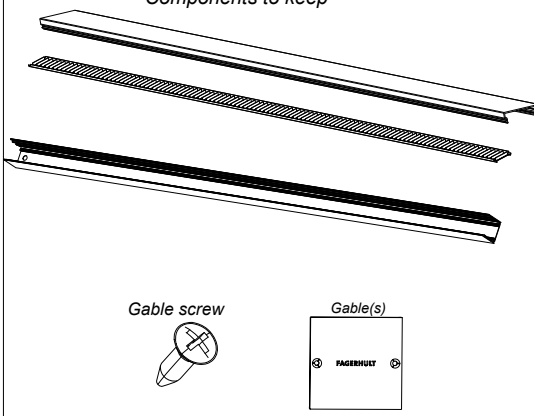

Gable screw

Gable(s)

Härmed försäkrar Fagerhult att dessa typer av radioutrustningar T0185R, T0186R, T0187R, T0188R, T0189R, T0190R, T0191R överensstämmer med direktiv 2014/53/EU.  
Hereby, Fagerhult declares that the radio equipments type T0185R, T0186R, T0187R, T0188R, T0189R, T0190R, T0191R are in compliance with Directive 2014/53/EU and UK SI 2017 No. 1206.

Den fullständiga texten till EU-försäkran om överensstämmelse finns på följande webbadress: [www.fagerhult.com/declaration-of-conformity](http://www.fagerhult.com/declaration-of-conformity)  
The full text of the EU declaration of conformity is available at the following internet address: [www.fagerhult.com/declaration-of-conformity](http://www.fagerhult.com/declaration-of-conformity)

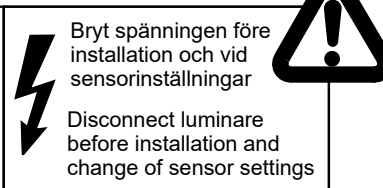
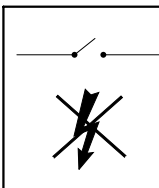

Bryt spänningen före installation och vid sensorinställningar

Disconnect luminaire before installation and change of sensor settings

Operating frequency bands and output power (EIRP):  
Frequency band: 2.4 GHz  
Output power (4dBm max within our operating band)

Ⓢ Det är lämpligt att denna information överlämnas till användaren av anläggningen.

Ⓒ It is appropriate that this information is passed on to the users of the installation.

Manufactured by Fagerhult  
For UK market importer Fagerhult UK  
33-34 Dolben Street, London, SE1 0UQ

# FAGERHULT SE - 566 80 Habo

## Notor G2 ReLight Organic Response

### Montering/Assembly

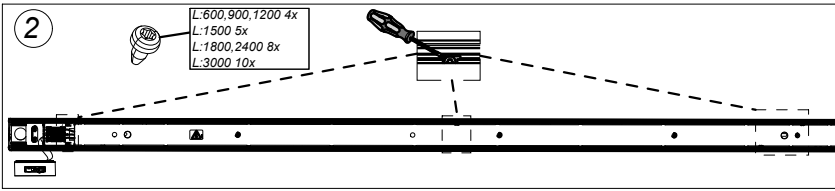
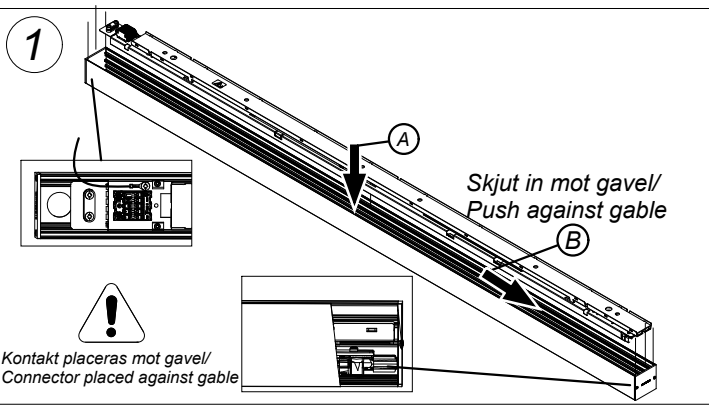
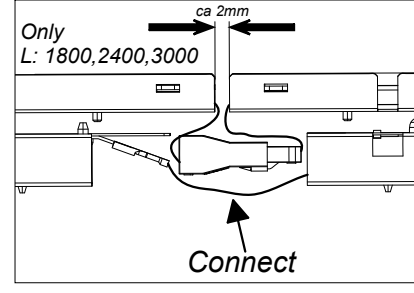
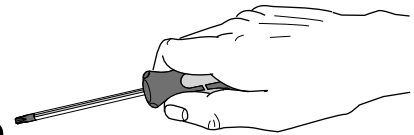

Följande steg gäller vid montering i tak/pendel  
Following steps applies at mounting in ceiling/pendant

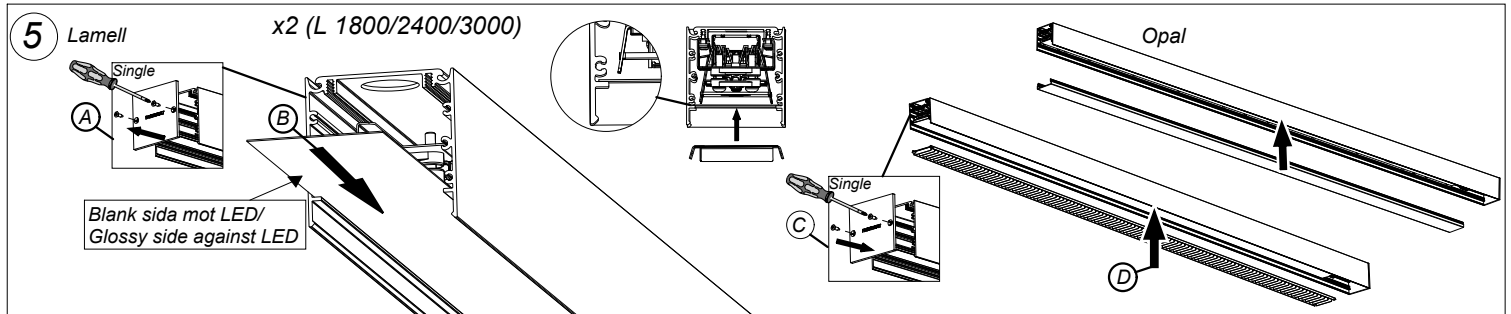
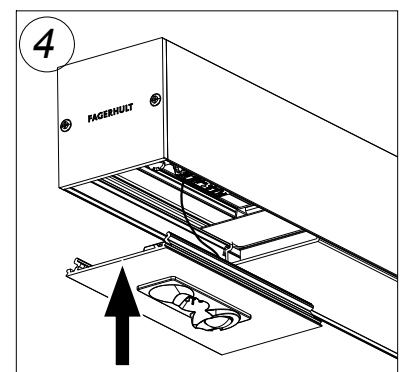
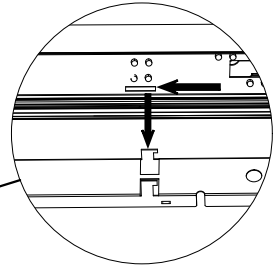
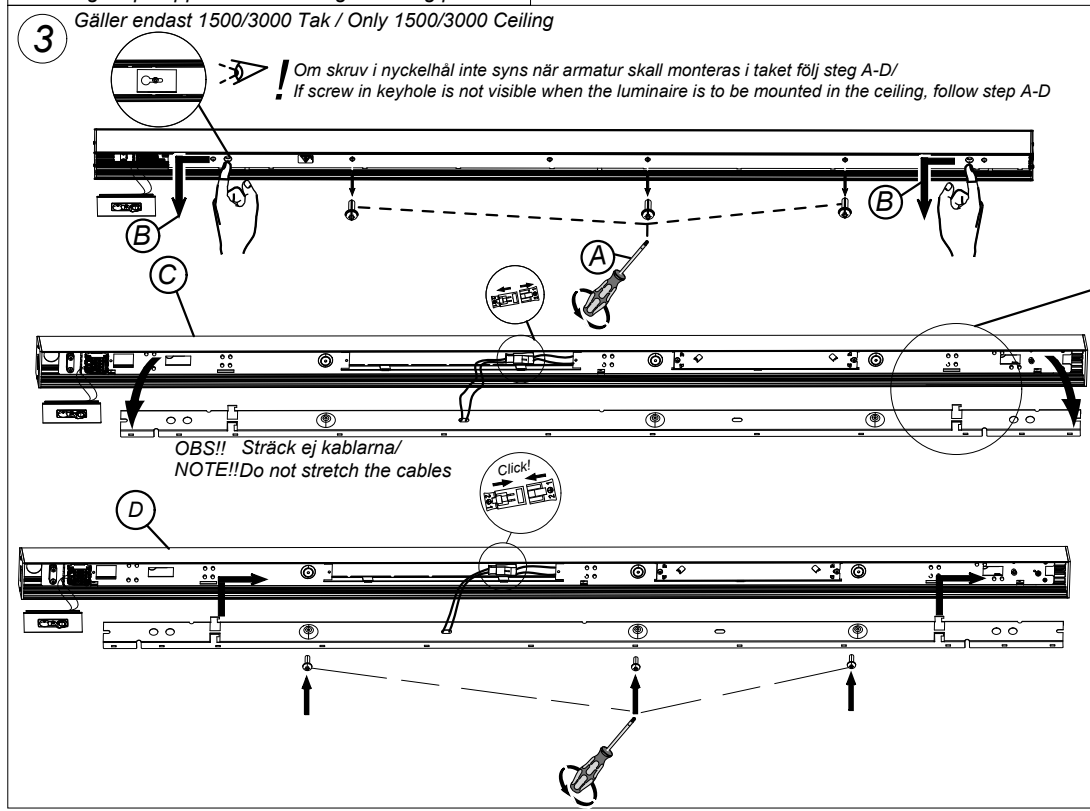

5466099 Utgåva/Edition 04

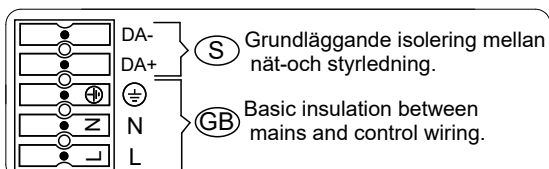

**S** Denna produkt innehåller en ljuskälla med energieffektivitets klass C  
**GB** This product contains a light source of energyefficiency class C

**S** Ljuskälla och drivdon ska enbart bytas ut av tillverkaren eller dess utsedda person.  
**GB** The light source and control gear shall only be replaced by the manufacturer or its designated person.

**S** Det är lämpligt att denna information överlämnas till användaren av anläggningen. **GB** It is appropriate that this information is passed on to the users of the installation.

Manufactured by Fagerhult  
 For UK market importer Fagerhult UK  
 33-34 Dolben Street, London, SE1 0UQ

# FAGERHULT SE - 566 80 Habo

## Notor G2 ReLight Start/Single

Demontering av gamla lysrörskomponenter  
Disassembly of old fluorescent tube components

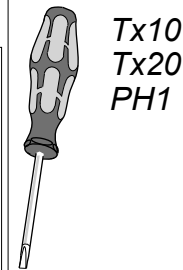
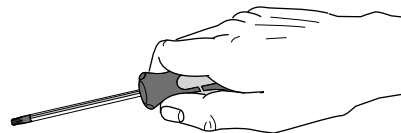

New Opal  
Order-nr  
L=1200: 96500  
L=1500: 96501  
L= 900: 96499

Note: New lamell louvre is not available

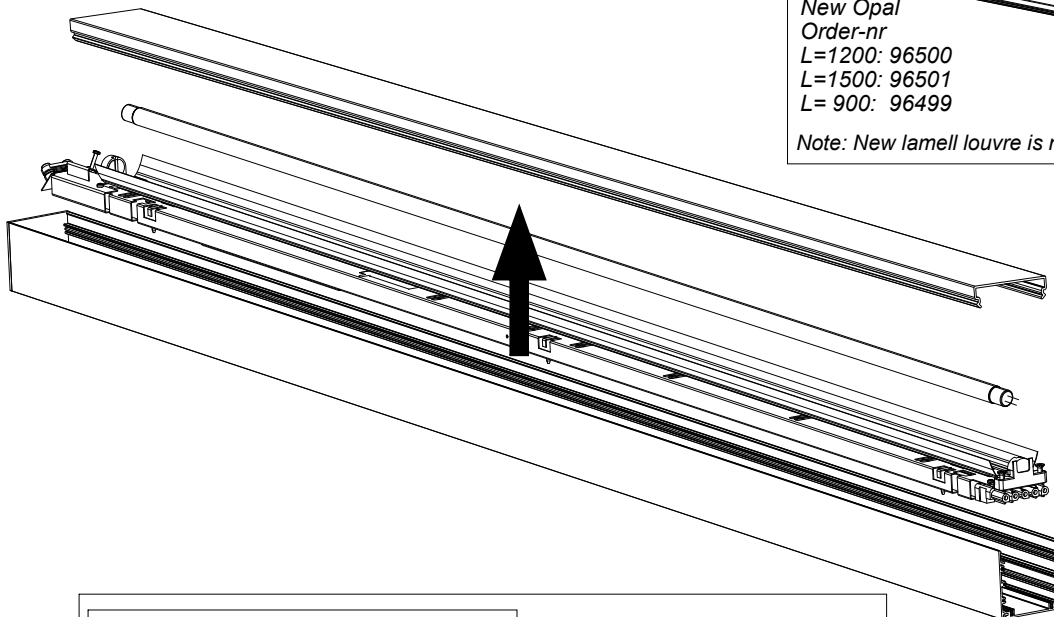

Only single

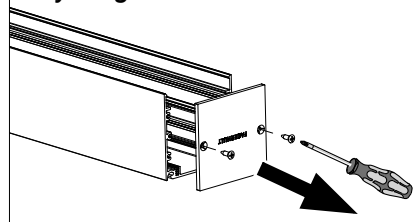

Demontering av lamellbländskydd/  
Disassemble lamell louvre

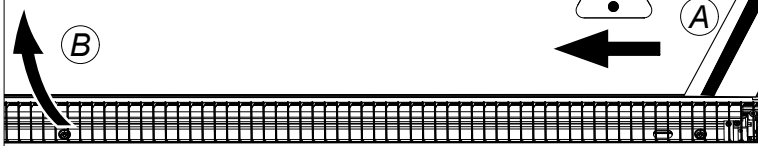

Komponenter till återvinning/  
Components to recycling

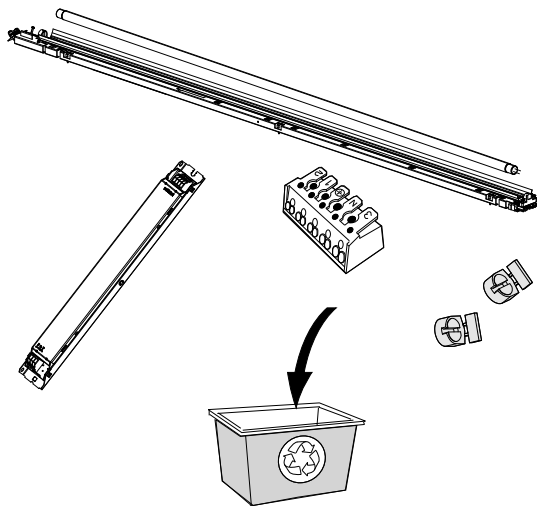

Komponenter att behålla/  
Components to keep

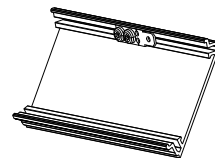
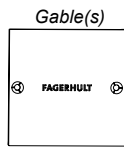
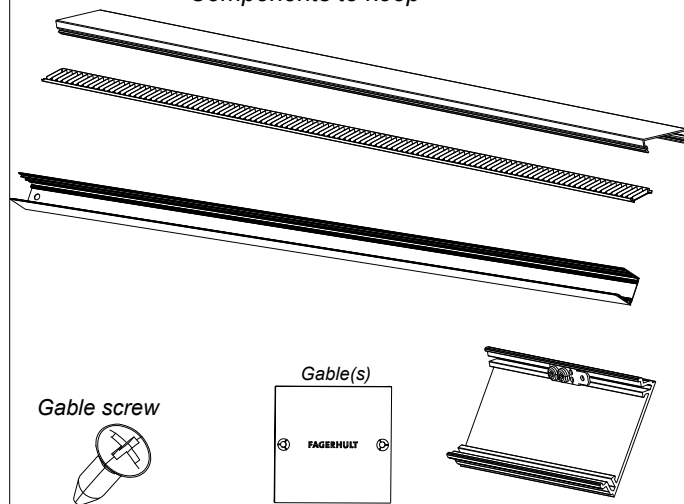

5465668 Utgåva/Edition 04

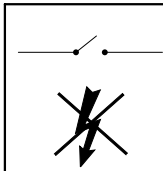

Bryt spänningen före installation och vid sensorinställningar

Disconnect luminare before installation and change of sensor settings



**(S)** Ljuskälla och drivdon ska enbart bytas ut av tillverkaren eller dess utsedda person.

**(GB)** The light source and control gear shall only be replaced by the manufacturer or its designated person.

**(S)** Denna produkt innehåller en ljuskälla med energieffektivitets klass C

**(GB)** This product contains a light source of energyefficiency class C

**(S)** Det är lämpligt att denna information överlämnas till användaren av anläggningen.

**(GB)** It is appropriate that this information is passed on to the users of the installation.

Manufactured by Fagerhult  
For UK market importer Fagerhult UK  
33-34 Dolben Street, London, SE1 OUQ

## Notor G2 ReLight Start/Single Montering/Assembly

**1**  
Montera en gavel vid änden som fixtur/  
Assemble a gable as fixture.

**2**

Skjut in mot gavel/  
Push against gable

Kontakt placeras mot gavel/  
Connector placed against gable

Demontera gaveln när det är start armatur/  
Dismantle the gable when it's start luminaire

**3**

L:600,900,1200 4x  
L:1500 5x  
L:1800,2400 8x  
L:3000 10x

Only  
L:1800,2400,3000

ca 2mm

Connect

Följande steg gäller vid montering i tak/pendel  
Following steps applies at mounting in ceiling/pendant

**4** Gäller endast 1500/3000 Tak / Only 1500/3000 Ceiling

Om skruv i nyckelhål inte syns när armatur skall monteras i taket följ steg A-D/  
If screw in keyhole is not visible when the luminaire is to be mounted in the ceiling, follow step A-D

OBS!! Sträck ej kablarna/  
NOTE!! Do not stretch the cables

Click!

**5**

**6** Lamell

x2 (L 1800/2400/3000)

Opal

Blank sida mot LED/  
Glossy side against LED

**S** Det är lämpligt att denna information överlämnas till användaren av anläggningen.

**GB** It is appropriate that this information is passed on to the users of the installation.

Manufactured by Fagerhult  
For UK market importer Fagerhult UK  
33-34 Dolben Street, London, SE1 0UQ

●	DA-	S	Grundläggande isolering mellan nät-och styrledning.
●	DA+		
⊕	⊕	GB	Basic insulation between mains and control wiring.
●	N		
●	L		